

Adhesives & Composite Panels for door construction

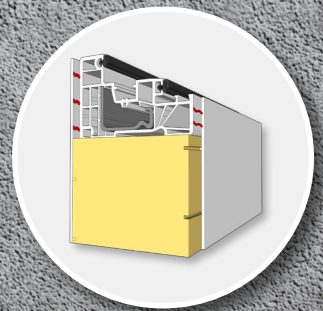

weiss

Adhesives & Composite Panels for door construction

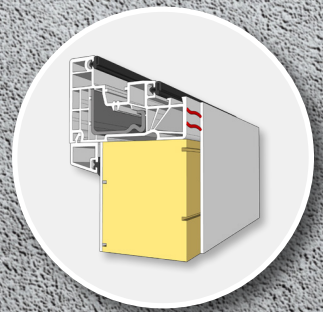
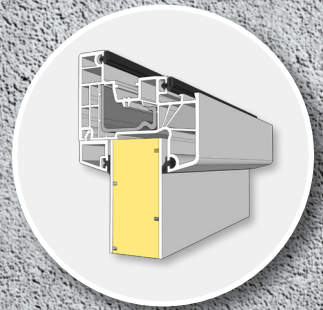

COSMO® Adhesives for leaf-enclosing entrance door panels

Adhesive system	Adhesive basis	Viscosity	Shore hardness	Pot life	processing time	Functional strength
COSMO® HD-200.101	2-C-STP-Adhesive	approx. 150.000 mPa.s	approx. 63 Shore A	approx. 30 min	approx. 15 min	approx. 3.5 h
COSMO® HD-200.121	2-C-STP-Adhesive	approx. 215.000 mPa.s	approx. 63 Shore A	approx. 11 min	approx. 8 min	approx. 1 h

Flexible, tension compensating 2-C-STP adhesives	Controlled curing and process times	H351 No marking required	As per criteria GEV EMICODE EC2	Not Foaming	

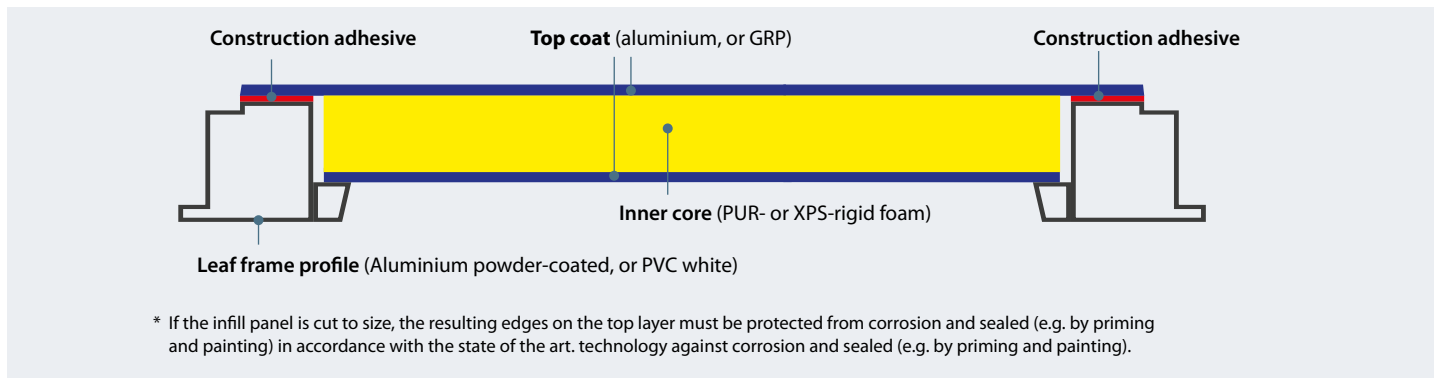

For preparation of bonding strongly recommend

Activator COSMO® CL-310.110

- It cleans and activates bonding surfaces
- It improves bonding on PVC, ABS, PC, PET, and GRP on the basis of polyester or polyamide and on powder-coated surfaces
- It improves the ageing resistance of adhesive joints with concrete, cellular concrete, sandstone and building brick



Special cleaner COSMO® CL-300.150

- Cleaning of bonding surfaces before bonding
- For powder-coated and anodised surfaces, fast drying
- It removes dust, adhesive residues of the protective film, marking pencil, rubber residues, fresh PUR foam and fresh sealant residues, as well as tar / bitumen



COSMO® Composite Panels for Door Panels

COSMO® Therm - ALU
ALU on both sides, XPS core

Top coats:
Aluminium coated as per RAL, NCS or DB colour system, other special colours on request, also deliverable with anodized surface

Core material:
Polystyrene-rigid foam, extruded (XPS)

- UV and weather-proof
- Moisture-resistant

HCG 035

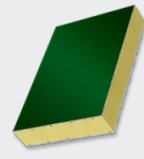

Weiss Chemie + Technik GmbH & Co. KG
Hansastr. 2
D-35708 Haiger
www.weiss-chemie.de

Phone: +49 (0) 2773 / 815 - 0
ks@weiss-chemie.de
se@weiss-chemie.de



Further technical information
about bonding of leaf-enclosing
entrance door panels?