

COSMO Adhesives & Composite panels

weiss

NEW PRODUCTS 2018
Innovations made by Weiss

Quality, service and high delivery reliability are the basic pillars of the success of our group of companies. We have continuously improved and further developed our portfolio in the past years, including through the acquisition of new companies. By now, about 300 employees at four sites participate in the success of our group.



Company

By pooling the core competences of adhesives and composite panels under a single roof, we are able to offer solutions from one source to our customers that are both economical and of high technical quality.

We are among the leading manufacturers in both segments in Europe and moreover, we also increasingly sell our products outside of Europe, such as in China, Russia and the USA.

Company history

Since the company's foundation in 1815, Weiss has developed from a small hide-glue producer to an internationally acting, industrial company for modern adhesive systems and composite panels. With a passion for quality and the aspiration to meet our customers' high expectations, we are a recognised and reliable partner on the market.

! Weiss is the only enterprise that produces adhesives and composite panels.

Powerful product range

Business area Adhesives



Permanent solid connections

Traditional bonding technologies like riveting, soldering, welding, or screwing are more and more replaced by modern adhesive systems, resulting in many advantages.

Our product range includes more than 400 variants of surface and construction adhesives, as well as instant and special adhesives for a wide variety of applications.

Business area Composite panels

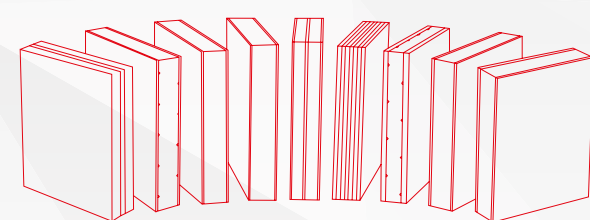

Unlimited possibilities of design

Composite panels made by Weiss leave nothing to be desired. Because there is a large number of top coats and core materials available as well as the possibility of combining and processing them in many different ways, a vast number of creative designs results for the finished element.

Our new products at a glance

Innovations made by Weiss

Weiss is offering highly loadable adhesive systems tailored to special requirements of the various applications. On the basis of our long-term experience in the in the building practice and the intensive exchange of experience with our customers in industry and trade, we have the possibility to continuously develop ourselves in adhesive technology.

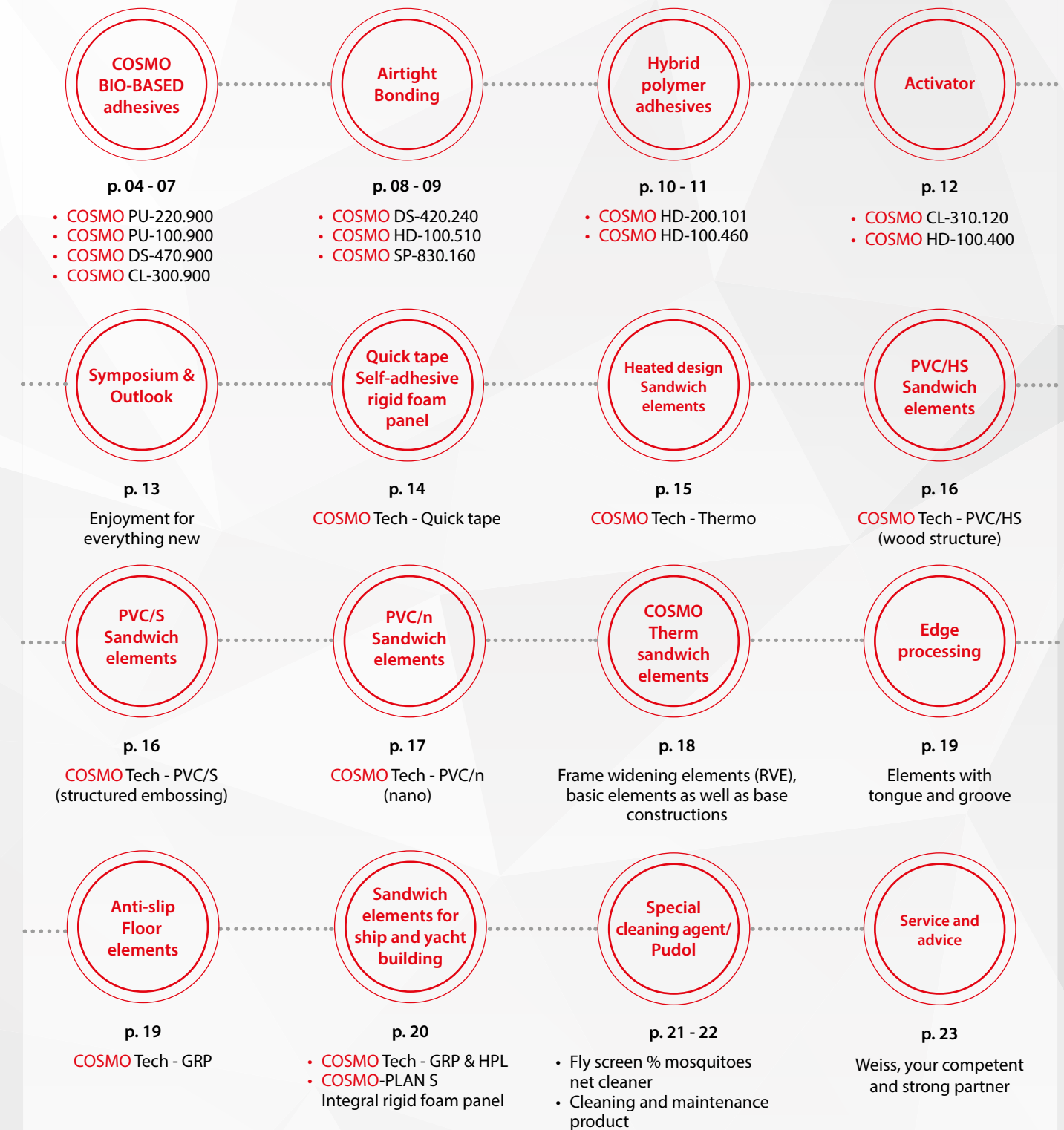

COSMO BIOBASED



Environmental thinking - not waiting!

The world's population is increasing - but our fossil resources are decreasing. So, more than ever before, it is essential to think of a sustainable future! Exactly for these reasons, sustainability, particularly regarding environmental protection, is of particular importance. It is therefore also an important subject for Weiss, not only for today, but also for future generations.

Responsible management of our water protection, exhaust gasses, and waste cycles already form part of our firmly established standards. And now, to further optimize our utilization of resources, we are concentrating on replacing fossil fuels in our adhesives with renewable resources.



Ecological sustainability - bio-based adhesives

Our bio-based adhesives actively contribute to the protection of the environment: As innovative products, they have been developed with particular consideration for our limited resources, yet without losing sight of the top quality which we consider a matter of course.

To a large extent, many of these raw materials produced by agricultural and silvicultural processes are climate-neutral. This way, no increase of CO₂ emissions will be generated in the future. Environmental and limited resources will be protected for further generations.

In the meantime, there are numerous possibilities for processing the most diverse bio-based materials such as starch, vegetable oil, resins, lignins, proteins, and others. It is also possible to use renewable raw materials in adhesives. By substituting fossil resources, we have succeeded in developing adhesives which contain a certain amount of bio-based products.



Optimization of our adhesives

Our bio-based adhesives include a high content of raw material from renewable sources. Simultaneously we are further improving their already very good properties. Sustainable quality... **made by Weiss!**

The ecological premium adhesive

COSMO PU-220.900 (2-K-PUR assembly adhesive)

Application:

Is used in the surface bonding of XPS, GRP, steel sheet, anodised aluminium, stainless steel, mineral wool, PVC, etc.

Properties:

- Contains approx. 50 % bio-based carbon content
- Very low foaming with moist materials
- Tough-elastic adhesive joint
- Adheres to a wide variety of substrates
- Excellent wetting of substrates
- Very hydrophobic, thus good water resistance
- Optimum for vacuum pressing

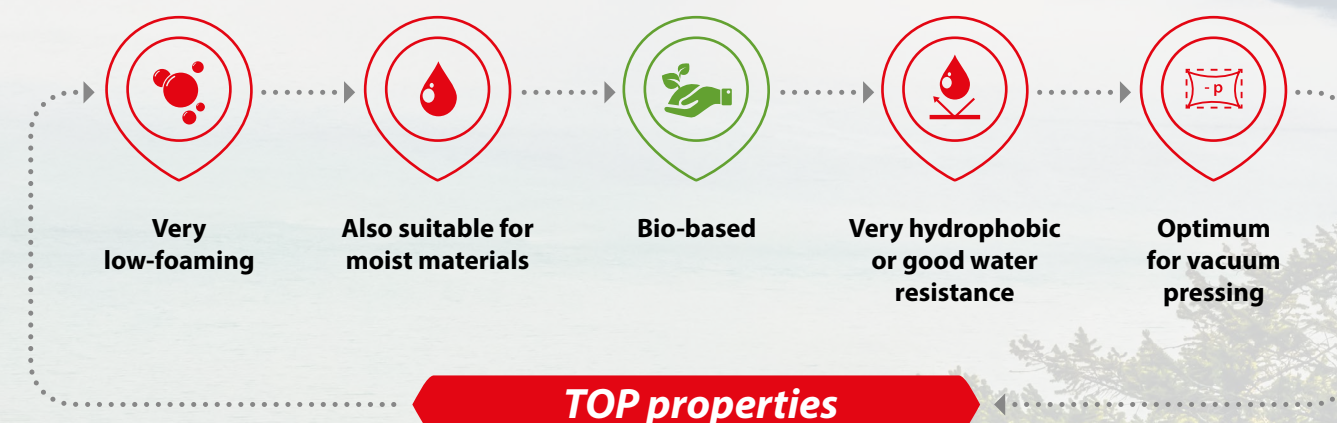
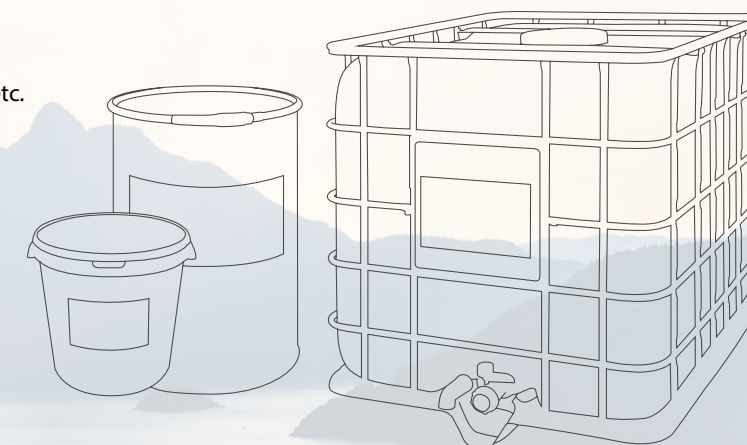

Examples for application

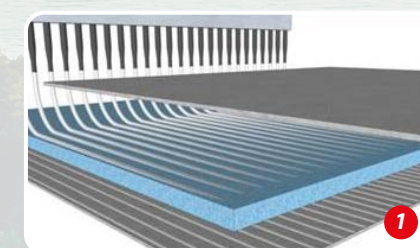

1 Optimum & durable surfacebonding of different types of materials

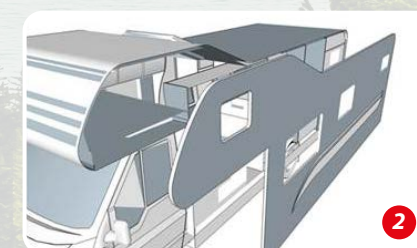

2 Ecologically sustainable production



3 Can be used for almost all application techniques



4 & 5 Sandwich bonding for box-style superstructures, e.g. for caravans/ motorhomes, sales vehicles and parcel service vehicles

The sustainable adhesive

COSMO PU-100.900 (1-K-PUR assembly adhesive)

Application:

- For universal use
- With aluminium window and door construction for bonding corner connectors
- Window and door construction
- Board joint bonding of panels in the wood, window and front door areas
- Stair construction and building trade
- With many assembly bonding processes
- With laying of skirting and laminate
- Fixation of struts for double floorings
- Fixation of signs
- Diverse industrial fields

Properties:

- DIN-certified BIO-BASED 20-50%
- **Contains approx. 26 % bio-based carbon content**
- Semi-hard adhesive joint
- Solvent-free
- Thixotropic, does not drop off
- Compatible with natural stone
- Expands (foams) during the curing process!
- Joint-filling
- Particularly fast reaction time
- Uniform curing
- Very short pressing times
- Good bonding strength
- Good adhesive properties to several types of wood and building material, ceramics, metal, TS polymers and thermoplastics after corresponding preparation of the surfaces
- Achieves durability class D4 as per EN 204 and a heat resistance of 7.5 N/mm² as per DIN EN 14257 (WATT 91) if wood is glued to wood
- Good weather-resistance
- Can be over-coated with many paint systems
- Can be ground when cured



8C093



Examples for application



1 Natural stone



2 Wooden staircase



3 Fibre insulating board

Certification

The "DIN-certified bio-based" label / www.dincertco.de

A neutral and transparent quality label regarding the content of bio-based carbon and the product quality makes finding resource-efficient products easier. By using the "DIN-certified bio-based" label, it is certified that we use bio-based raw materials and undergo regular monitoring.



8C092 / 8C093

The ecological adhesive

COSMO DS-470.900 (adhesive sealant for vapour barriers)

Application:

Air-tight bonding of vapour checks and barriers and sealing films

Properties:

- DIN-certified BIO-BASED 20-50%
- **Contains approx. 47 % bio-based carbon content**
- Self-adhesive after curing
- High strength on a wide variety of film types
- Very easy to apply, particularly at low temperatures
- Fast curing
- Solvent-free
- Can be applied using the contact bonding method
- GEV-EMICODE EC1^{PLUS}, very low-emission



8C092



The environmentally friendly

COSMO CL-300.900 (intensive cleaning agent)

Application:

Intensive cleaning of plastics and metals (slightly dissolving on plastic)

Properties:

- **Contains approx. 80% bio-based raw material content**
- Intensive cleaning effect
- Mild odour during processing
- Quick evaporation
- Reduced marking
- Reduced workplace loading
- Low requirements on storage conditions



Certification

Low-emission adhesives from Weiss / www.emicode.de

GEV-EMICODE®-licensed products

EMICODE® is a recognised standard for construction products promoting healthy living and is a quality label for the proof of low VOC-emissions. Products labelled with EMICODE® are modern, solvent-free and low-emission construction products.



Airtight Bonding

The topics of air tightness and wind tightness, as well as rain tightness for new constructions, renovations, etc. are among other things requirements from EnEV 2016 / DIN 4108 and have become more and more important in recent years, and not only because of continuously rising energy costs and the increasing impact on the environment. In this process, preservation of building stock plays an equally important roll, because this effectively prevents expensive repair measures caused by structural damages.

However, the means used in this context, such as vapour barriers, window joint tapes and roof underlays, are only effective if they are bonded permanently and securely to the respective substrate. The **COSMO Airtight bonding** system creates such solid and permanent bonds, thus providing the necessary security you need.

Weiss – A strong partner for the system business!

Adhesive sealant for vapour barriers

COSMO DS-420.240

Application:

Air-tight bonding of vapour checks and barriers as well as sealing films

Properties:

- Solvent-free, joint filling, self adhesive, permanently elastic adhesive sealant with very high initial adhesion
- The adhesive meets the requirements of DIN 4108-11
- Safety for the processors / users due to the high-quality adhesive for durable and age-resistant bonding strength
- Frost resistance up to -26°C
- GEV-EMICODE EC1^{PLUS}, very low-emission
- Hardening of the adhesive can be recognised visually



Examples for application

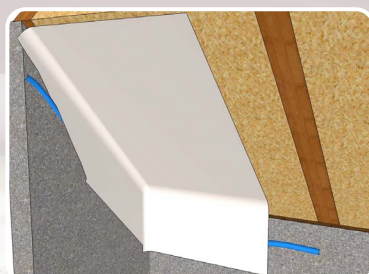

Adhesive sealant for vapour barriers
Bonding of vapour checks and barriers as well as sealing films

Additional benefit with COSMO DS-420.240

Immediately in view: Indicator for hardening state of the mass!



Figure a: Adhesive is light blue when in a fresh state



Figure b: Adhesive is transparent blue after hardening

Assembly adhesive sealant

COSMO HD-100.510

Application:

Bonding and sealing of fleece-laminated joint tapes
For window and door assembly

Properties:

- Flexible adhesive sealant
- Solvent-free
- Joint-filling
- Compensates for expansion of different materials
- Very good application possibilities
- Good early rain resistance
- Optimally suitable for RAL assembly

Perfect in team with:

Primer

COSMO SP-830.160

Application:

Adhesion promotion and improvement of, amongst others, acrylate adhesive tapes on various absorbent mineral substrates.

Properties:

- Smooth, long-term adhesive film after curing
- Fast drying even at low temperatures
- Very high bonding strength
- Solvent-free
- Good processing viscosity
- GEV-EMICODE EC1^{PLUS}, very low-emission



Examples for application

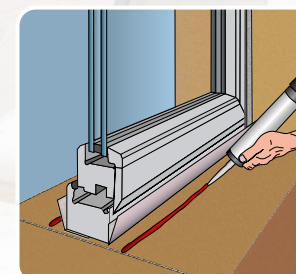

Assembly adhesive sealant COSMO HD-100.510
Bonding of joint tapes with window and door jambs

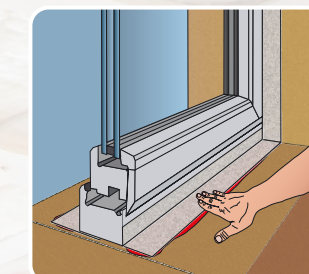
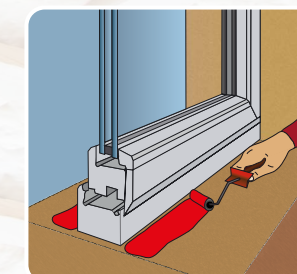
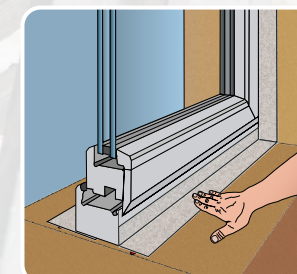

Primer COSMO SP-830.160
Pretreatment of the substrate for self adhesive joint tapes

Hybrid-polymer adhesives

We have been working with hybrid-polymer adhesives, also called **MS**, **STP** or **SPUR**, for almost a decade now.

The basic formula developed at the time has since been continuously expanded by a number of important variants. Together, all hybrid-polymer adhesives have a low impact on the person working with the product, as they **DO NOT CONTAIN** ingredients such as isocyanate, solvent and other, strongly sensitising substances dangerous to health. The statement "Primer on board" is also to be taken literally, since no additional primer is needed for many materials – such as aluminium –, as opposed to other systems, for example on the basis of PUR.

Last but not least, all these products have excellent weathering resistance, for example against UV, moisture, frost, and heat. Since we feel that the tendency towards hybrid adhesives is clearly undiminished, we are continuously expanding our portfolio in order to meet the requirements of the markets or perhaps even actively shape future needs.

Trend-setting with our own development – COSMO HD

The controlled adhesive

COSMO HD-200.101 (2-K-STP construction adhesive)

Application:

Used for bonding and sealing assembly applications both indoor and outdoor.

Properties:

- Suitable for thick adhesive joints, without curing problems
- Elastic adhesive joint
- Fast and controlled curing
- High tear resistance
- Adding moisture to the adhesive joint is not necessary
- Full process control
- Adheres to a wide variety of substrates
- High weather-resistance
- Can be coated over
- No H351 (R40) marking



Examples for application



! Simple and cost-effective dosing of the uTAH cartridge using a commercially available cartridge gun.

Assembly adhesive with biostatic properties

COSMO HD-100.460

Application:

- Construction of ventilation systems, ventilation technology (HVAC)
- Used for bonding and sealing in automotive and vehicle body manufacture
- Assembly bonding
- Skirting, laying of laminate and cable ducts
- Stair construction and building trade
- Bonding of façades (cassettes / panels) - composite panels
- Glass bonding in furniture and display cabinet construction
- Solar and wind power plants
- Fixation of signs
- Apparatus and plant construction
- Diverse industrial fields

Properties:

- Bacteriostatic and fungistatic effect
- Suitable for the application in ventilation technologies (HVAC) (meets the requirements of VDI 6022, sheet 1)
- Elastic adhesive joint
- Solvent-free
- Compatible with natural stone
- Not foaming
- Low shrinkage
- Good adhesive properties to different surfaces
- Surface can be smoothed well
- High strength of adhesive joints
- Compensates for expansion of different materials
- Good weather resistance outdoors
- Good UV resistance
- GEV-EMICODE EC1 PLUS, very low-emission



A fantastic joint:

COSMO HD-100.460 and PVC/n (nano) (see page 17)

Characteristics

With **COSMO HD-100.460**, we offer a **bacteriostatic and fungistatic adhesive** that complies with all the requirements of VDI 6022, sheet 1 (07/2011) regarding the microbiological resistance to metabolism in accordance with DIN EN ISO 846.



Activator

You cannot tell by the look of it whether a certain plastic material can be bonded well. Some even cannot be bonded at all. In order to guarantee the highest security of the bond possible, we offer our **COSMO CL-310.120** activator for various surfaces.

Particularly with regard to adhesive standard DIN 2304, the definition of the bonding process is becoming increasingly more important. Part of this clear determination is always also an absolutely defined and flawless bonding surface. Using the activator guarantees this.

Making bonding even more secure – COSMO CL-310.120

Fluorescent activator

COSMO CL-310.120

Application:

- Activation of bonding areas before bonding with adhesives of the **COSMO HD** product range.
- Activation of non-absorbent, porous and smooth substrates.
- Activation of mineral surfaces.

Properties:

- Fluorescent
- Cleans and activates bonding surface
- Particularly improves the bonding to PVC and powder-coated surfaces
- Noticeable improvement of the bonding on the basis of ABS, polycarbonate, GRP on the basis of polyester or polyamide
- Improves the ageing resistance of adhesive joints with concrete, aerated concrete, sandstone and building brick significantly

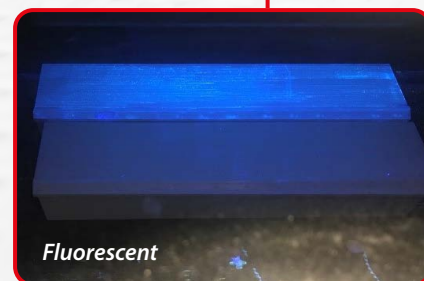

Perfect in system with:

Sealing adhesive

COSMO HD-100.400

Application:

- Used for bonding and sealing in automotive and vehicle body manufacture
- Assembly bonding
- Skirting, laying of laminate and cable ducts
- Mirror bonding
- Stair construction and building trade
- Bonding of façades (cassettes / panels) - composite panels
- Glass bonding in furniture and display cabinet construction
- Solar and wind power plants
- Fixation of signs
- Apparatus and plant construction
- Diverse industrial fields

Properties:

- Low water absorption
- Low shrinkage
- Good adhesion values to different surfaces
- Compensates for expansion through elastic adhesive joints
- High strength of adhesive joints
- Very good UV stability
- High weather resistance
- Can be easily coated over
- Elastic, 55 Shore A
- GEV-EMICODE EC1^{PLUS}, very low-emission
- Solvent-free



Symposium at Weiss

Topic: Bonding of surfaces

Potentials by DIN 2304, application technologies and bio-based adhesive systems

When? Autumn 2018

Where? Haiger location

Program preview

Fraunhofer-Institut für Fertigungstechnik und Angewandte Materialforschung IFAM, Bremen
Prof. Dr. Andreas Groß

Topic: DIN 2304



Oest GmbH & Co. Maschinenbau KG

Topic: Automation and process reliability



Manufacturer of XPS & GRP

Topic: Possible sustainable materials & outlook

Weiss Chemistry and Technology

Topic: Bio-based surface adhesive



For further information, please contact
Mr. Andre Körfer
(AWT/PM):
+49 (0) 2773 / 815-279

Outlook

You can look forward to the following new products soon:

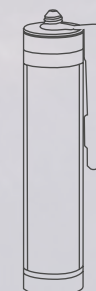

COSMO HD-110.110

- Reactive adhesive sealant for airtight bonding
- Permanent bonding

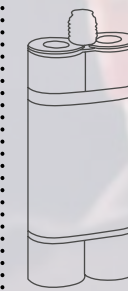

Bio-based 2-K-PUR construction adhesive

- Not subject to labelling with H351 (R40)
- UV colour-fast
- 60% bio-based carbon content



1:1 Alternative to COSMO HD-200.101

- 2-K-STP adhesive in conventional Weiss tandem cartridge, mixing ratio 1:1

QuickTape - self adhesive hard-foam board

now also with COSMO TP core

Quick Tape – the hard-foam board / TP-panel with self-adhesive surface on both sides – makes the fast and easy production of composite panels possible without the use of additional adhesive systems. Due to the instant adhesion of the top coats on the adhesive film, elements produced using **Quick Tape** can be used immediately.

TP (thermoplastic polymer) is the ideal foam material from the polyester material family and is perfectly suited as construction material. The advantage of this foam is the unique combination of material and processing properties. High structural strength at low weight and excellent temperature stability are the most important factors that distinguish **COSMO TP** from traditional core materials.

The closed cellular structure prevents the moisture absorption, making it ideal for the use in damp rooms. Another important advantage is its recyclability. It makes **COSMO TP** attractive particularly for applications focusing on "eco-friendliness".

The elements are available in the standard formats of 3,000 x 1,000 mm and 2,000 x 1,000 mm.

COSMO Tech - Quick tape

Application:

- For façade elements, door panels, roof and wall elements and industrial gate panels
- Use in damp rooms (TP)
- Applications focusing on "eco-friendliness" (TP)

Properties:

- Fast bonding over the whole surface
- Immediate adhesion, fast action, and easy handling
- No handling of adhesive or silicone cartridges
- Moisture-resistant
- Screwable (TP)
- No uneven surfaces with thin top coats

Application example:

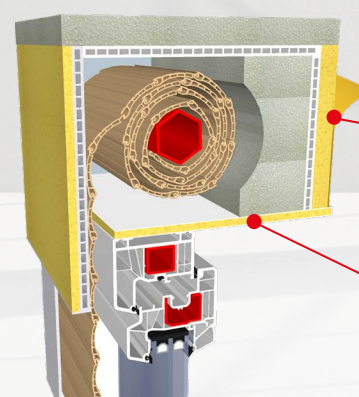

COSMO Tech - Quick tape
Is used in, e.g. the field sun protection technology for roller shutter housings

COSMO Plan S integral rigid foam panel
Product, see page 20.

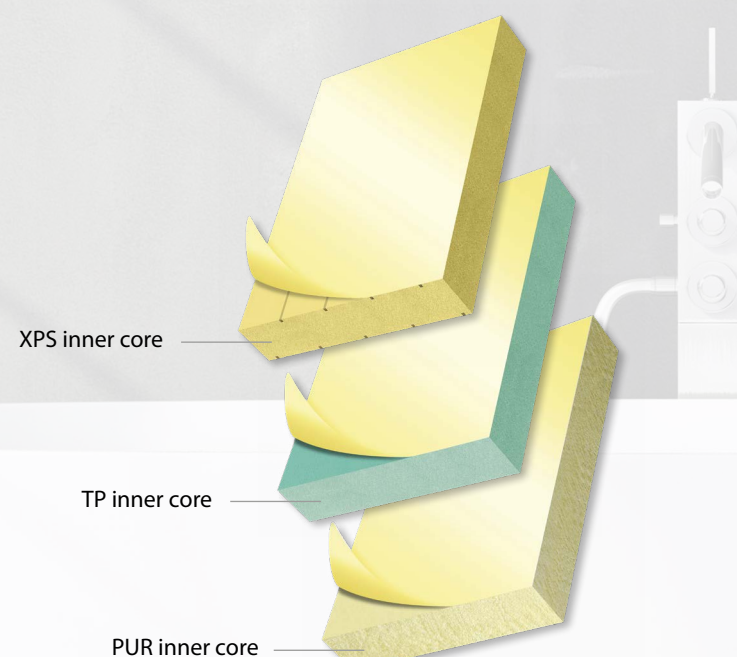

Heated design composite panels

Know-how and the spirit of innovation united in a sandwich element. The heated design composite panels make efficient solutions possible for rooms that are to be heated. This way, it is possible to create comfortable radiant heat for example in meeting rooms or salerooms. The fact that you can choose the design of the HPL surface as well as cover it with foil or have it printed is an additional advantage and makes a wide spectrum of applications possible. The integrated heating solution is a patented system. Heat is released due to low surface temperatures through about 70 % of heat radiation and 30 % of convection. This guarantees comfortable heat.

The system can be delivered in the standard formats of 2,000 x 1,300 mm and 1,500 x 1,100 mm.

COSMO Tech - Thermo

Application:

- Mobile and fixed planned heating elements for
 - shop building / exhibition stand construction
 - Container construction
 - Outdoor catering
 - Automotive manufacturing
- Suitable for e.g. waiting zones, room partitions, floor elements

Properties:

- Quick heating phase
- Heat radiation approx. 45°C
- No risk of burns
- Ensures for a comfortable temperature
- Suitable for moist rooms
- No CO₂ emission
- Patented system
- Very low power consumption 0.2 kWh - 0.8 kWh per hour
- Integrates seamlessly into the local overall picture with individual design

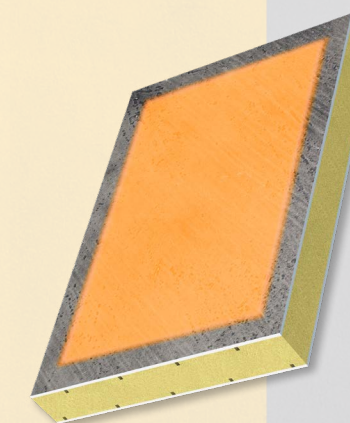

Examples for application:



Seating areas and waiting zones



Work places

PVC/HS (wood structure)

PVC/HS is an extruded rigid PVC top coat with a shaped wood-structure surface. The material is made of an unplasticised moulding compound and has increased impact resistance.

PVC/WS can be combined with all of our inner cores.

The material is available in the standard widths of 1,000 mm, 1,220 mm and 1,500 mm and in lengths of up to 3,500 mm. The minimum thickness is 1.3 mm.

PVC composite panels

COSMO Tech - PVC/HS

Application:

- Door and gate panels
- Parapet elements
- Partition panel systems
- Sanitary coverings

Properties:

- Increased impact resistance, high low-temperature impact resistance

- High light resistance and weathering resistance (colour white)
- Very good deep-drawing properties
- High-quality surface finish after vacuum moulding
- Especially suited for the production of relief-type door surfaces
- Self-extinguishing after withdrawal of the flame
- Easy application

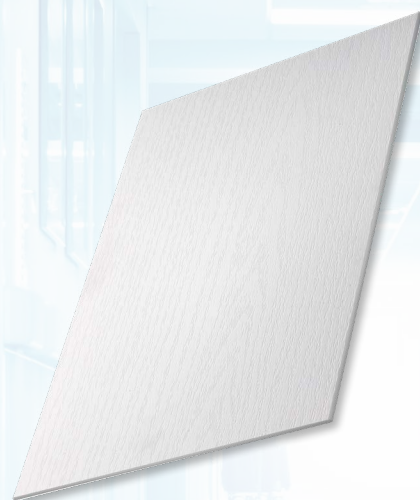

PVC/S (structured embossing)

Composite panels in proven **COSMO** quality with **PVC in structured embossing** (thickness: 2.0 mm) in attractive stucco design. You can choose between extruded polystyrene rigid foam (XPS), expanded polystyrene rigid foam (EPS), and thermoplastic polymer (TP) as inner cores, which can be reinforced with a sturdy insert, if necessary.

The elements are available in the standard formats of 2,500 x 1,250 mm, 3,000 x 1,250 mm and 3,000 x 1,500 mm.

PVC composite panels

COSMO Tech - PVC/S

Application:

- Ceiling, wall, and partition panel systems in labs and clean rooms
- Sanitary coverings

Properties:

- UV-resistant in accordance with DIN EN ISO 4892 and the requirements of RAL-GZ 716/1
- High low-temperature impact resistance

- according to DIN 53453
- Impact resistant according to DIN EN ISO 179.
- Not scratch-sensitive due to structured surface
- Wear-resistant
- Food-safe
- Good reflection of light
- Weather-resistant
- Easy processing using welding, thermoforming, or bonding



PVC/n (Nano)

PVC/n (Nano) is perfect for the use in germ-free rooms and clean rooms. The material has antimicrobial properties and makes the highest hygiene standards possible, such as apply in hospitals, for example.

The special silver-ion surface prevents the spreading of microbes (bacteria or fungi). The growth of microbes is physically prevented through the exchange of silver ions. The bactericidal effect of this material takes place very quickly and has been tested and certified by the Swiss company Ciba Spezialitätenchemie AG in Basel. This additive is harmless to humans.

The low surface tension extremely reduces the contact surface for particles and liquids for example, paint, graffiti, permanent marker making them very easy to remove.

The elements are available in the standard formats of 2,000 x 1,000 mm, 3,000 x 1,000 mm and 3,000 x 1,500 mm.

PVC composite panels

COSMO Tech - PVC/n (Nano)

Application:

- Treatment rooms
- Operating theatres
- Sickrooms
- Hallways in hospitals
- Care facilities
- Isolation wards
- Locks
- Pharmaceutical facilities
- Doctor's practices

Properties:

- Antimicrobial effect including against MRSA (as per mod. AATCC 100 / ISO 22196)
- Easy-to-Clean-Effect: easy to clean
- Nano-scale microstructure: low surface tension of < 18 mN/m (compared to standard PVC: 38-42 mN/m)
- Super-hydrophobic
- High chemical resistance
- Very high resistance to abrasion
- Good bondability
- A force of 4 N is necessary to generate a visually visible scratch on the surface.



A fantastic joint!

PVC/n (Nano)

with

COSMO HD-100.460

Assembly adhesive with biostatic properties (see page 11.)



COSMO Frame

Frame widening elements (RVE), basic elements as well as base constructions

Thermally insulated composite panels for widening the profile (frame widening), for base constructions (lifting and sliding doors) or window connection profiles in window construction.

The elements are available in the standard formats of 3,000 x 1,500 mm and 4,000 x 1,500 mm.

COSMO Frame - PVC

PVC on both sides, XPS/PR core

Properties:

- Noise insulating
- Moisture-resistant
- Weather-resistant

- UV resistant
- CFC- and HCFC-free
- Suitable for sawing, milling, grinding, slot cutting, screwing and drilling

COSMO Frame - PVC

PVC on both sides, XPS/TP core

Properties:

- Moisture-resistant
- Weather-resistant
- UV resistant
- CFC- and HCFC-free

- Suitable for sawing, milling, grinding, slot cutting, screwing and drilling
- Swelling-resistant and no changes of dimensions

COSMO Frame (dB) - PVC

PVC on both sides, XPS/PR core, heavy film insert

Properties:

- Moisture-resistant
- Weather-resistant
- UV resistant

- Airborne sound insulation
- CFC- and HCFC-free
- Suitable for sawing, milling, grinding, slot cutting, screwing and drilling

COSMO Frame (dB) - PVC

PVC on both sides, XPS/TP core, heavy film insert

Properties:

- Noise insulating
- Moisture-resistant
- Weather-resistant
- UV resistant

- Airborne sound insulation
- CFC- and HCFC-free
- Suitable for sawing, milling, grinding, slot cutting, screwing and drilling
- Swelling-resistant and no changes of dimensions

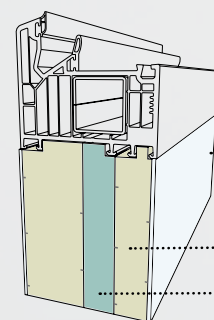

Example of application: RVE

Top coats: PVC compact panels, white with protective film

Core materials:

- Polystyrene-rigid foam, extruded (XPS)
- Thermoplastic plastics material (TP)

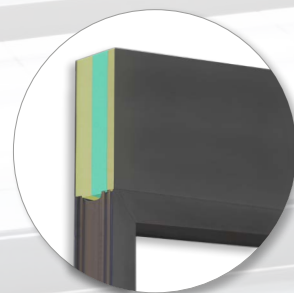

Edge work with tongue and groove

Markets and requirements change over time. While many processors preferred doing the profile furring and edge work themselves in the past, at present, requests for profiled off-the-shelf goods are increasing. In order to meet these wishes and requirements, we have invested in an ultra-modern edge-working centre. With it, we are able to process all standard material combinations.

Key data:

- Off-the-shelf goods up to 6,000 mm long
- Off-the-shelf goods up to 160 mm thick, depending on the version
- Off-the-shelf goods with individual widths
- Groove depth of up to 70 mm
- Complex edge geometries possible
- Minimum quantities on request

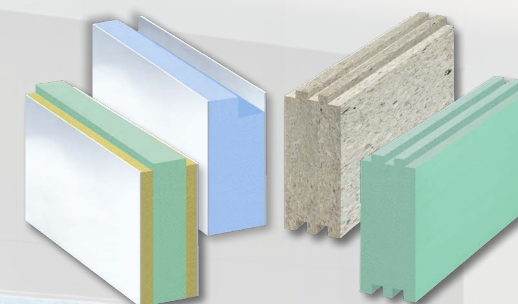

Sealing assembly adhesive for a simple and safe bonding of the elements on each other as well as with frame profiles, e.g. **COSMO HD-100.400** (see page 12).

Anti-slip floor elements for vehicle bodies

COSMO Tech - GRP

GRP on one side anti-slip, TP core, GRP on rear side, smooth

Application:

- Use in damp rooms
- Applications focusing on "eco-friendliness"

Properties:

- Minimum absorption of humidity
- Outstanding mechanical characteristics
- Low weight
- Screwable using commercially available screws
- Long-term water resistant
- Swelling-resistant, i.e. no changes of dimensions
- High pressure resistance
- Environmentally-friendly inserts (TP is 100 % recyclable)
- Slipping class R12 (fine), 13 (medium)

Formats (mm):

3.100 x 1.500 / 3.000 x 1.700 / 4.000 x 2.000

! Other surface qualities on request.



Application example:



Ship and yacht building

Especially in shipbuilding, special requirements are made on the elements to be used. We offer many different solutions that satisfy the high demands, for example on the moisture and UV resistance. Moreover, our elements offer a low weight and stand-out with their outstanding mechanical properties. Also observe our adhesive system with steering wheel certificate especially for shipbuilding!

COSMO Tech - GRP (GRP on both sides, TP core – also available in XPS)

Application:

In ceilings, module and furniture construction, for walls and floors

Core material properties:

- Minimum absorption of humidity
- Outstanding mechanical characteristics
- Low weight
- Screwable
- Long-term water resistant
- Swelling-resistant, i.e. no changes of dimensions
- High pressure resistance
- Environment-friendly core material (100 % recyclable)

Formats (mm):

2,000 x 1,250 / 2,000 x 1,800 / 2,300 x 1,250 / 3,000 x 1,500 / 3,000 x 1,800 / 4,000 x 2,000

COSMO Tech - HPL (HPL on both sides, TP core – also available in XPS)

Application:

In ceilings, module and furniture construction, for walls and floors

Core material properties:

- Minimum absorption of humidity
- Outstanding mechanical characteristics
- Low weight
- Screwable
- Long-term water resistant
- Swelling-resistant, i.e. no changes of dimensions
- High pressure resistance
- Environment-friendly core material (100 % recyclable)

Formats (mm):

2,800 x 1,860 / 2,800 x 2,070

Foil formats (mm):

2,150 x 900 / 2,150 x 1,150 / 3,050 x 1,150 / 3,050 x 1,300

COSMO Plan S integral rigid foam panel

Application:

The white surfaces have a noble satin effect. They are ideal for ceiling elements as well as for use in sanitary areas.

Properties:

- Good processing properties
- Fine, smooth surface
- Weather resistant & UV stable
- Versatile use
- Pressure resistant according to DIN EN ISO 844. >3 MPa
- Shore D according to DIN EN ISO 868: ~75

Formats (Length x Width x Height in mm):

3,000 x 1,250 x 8-30 / 3,000 x 1,560 x 10/19



Special cleaning agent for fly screens & mosquito nets

Application

Pollen dust on both sides, insect faeces and house dust from fly nets, mosquito nets and pollen protection grating made of nylon or metal.

Properties

- Highly effective
- Low foam formation for simple application
- CLP conform and no marking required
- In a practical set Spray bottle and cloth

Three application steps



- 1 Spray the cleaning solution from the bottle onto a clean cloth
- 2 Thoroughly clean the surface with the wetted cloth
- 3 Then wipe the cleaned surface using a clean wet cloth.

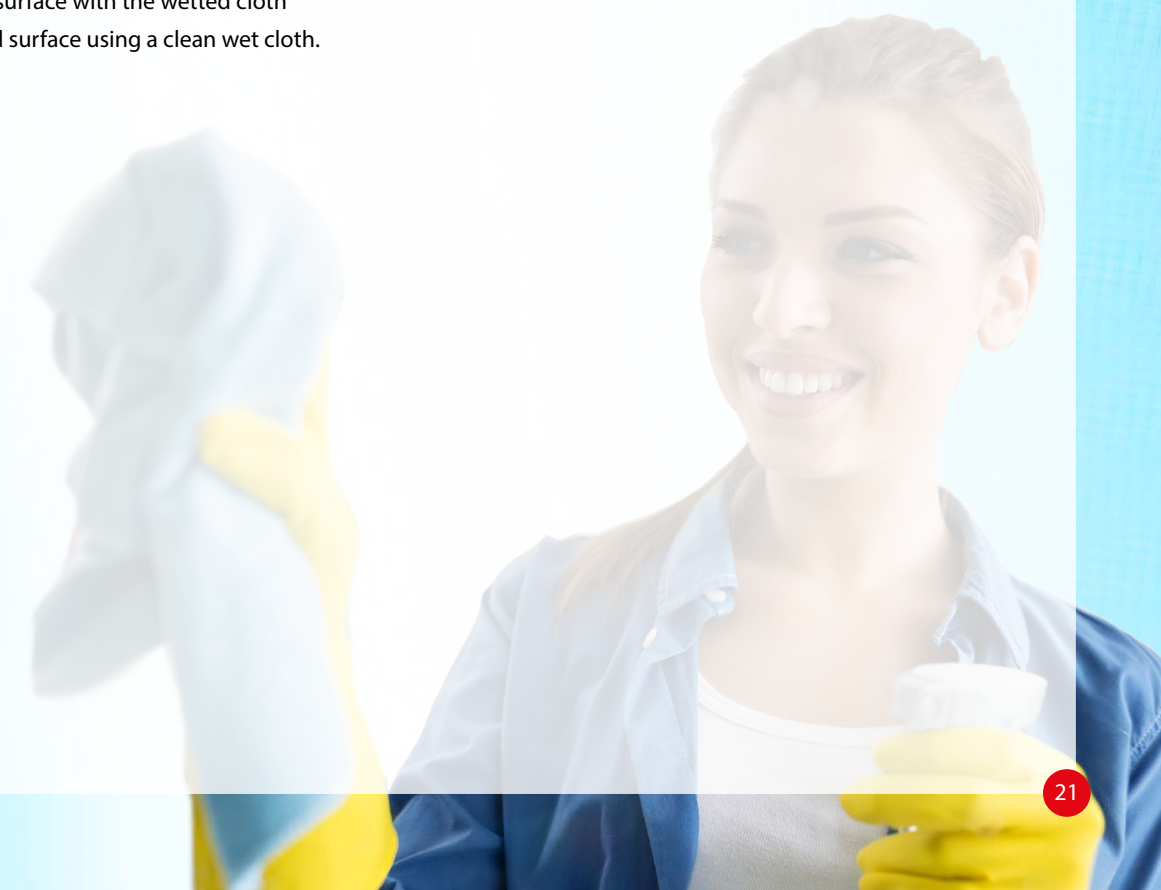

Pudol – Cleaning and care agent

Cleanliness refreshes your senses

PUDOL stands for convincing quality of special products in the field of commercial cleaning. Next to a complete range of cleaning and care products for different applications, we offer a comprehensive service with interesting solutions and benefits.



Our products and application fields

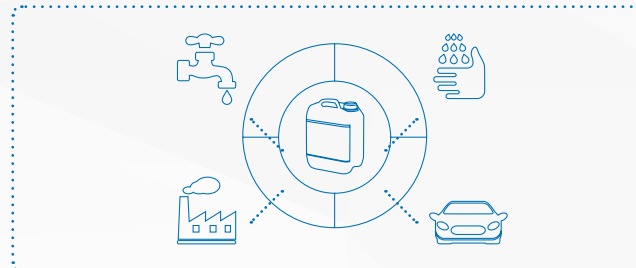

Product groups

- **PUDOL SOFT**
for sensible materials
- **PUDOL CARE**
for high-gloss hygiene
- **PUDOL POWER**
for extreme soiling
- **PUDOL FRESH**
for cleanliness and fresh air

Cleaning program

- Universal / multi-purpose cleaning agent
- Industrial cleaning agent
- Carpet cleaning agent
- Fresh cleaning agent
- Special cleaning agent
- Disinfection cleaning agent
- Floor cleaning agent
- Basic cleaning agent
- Wipe cleaning products
- Main care products

Fields of application

- Universal
- Flooring
- Sanitary installations
- Clothing care
- Foodstuff industry
- Household and gastronomy
- Special
- Windows & glass
- Dishwasher
- Carpet & upholstery
- Industry & workshop
- Skin cleaning & protection
- Cars



Our service and advisory performances

Weiss, your competent and strong partner

We strongly support you!

Weiss is representing top performance in the areas of **adhesive and sandwich element technology**.

For many decades, Weiss has been very successful in setting new market standards in terms of quality and excellent service. With our comprehensive product line of adhesives and sandwich panels, we are covering a wide variety of different applications.

Expert advice and service are counted to the elementary core competencies of our company. For all technical questions referring the application of our products the competent consultants of our Service Center will be available for you with their specialist knowledge.



Our service and advisory performances



Support with creating the requirements specification



Expert advice on product selection



Optimisation tips for the design of the bonding surfaces



Rationalisation proposals for work flows



Recommendation of suitable application devices as well as application and pressing technology



Optimisation of workstations for the processing of adhesives



Expert advice on all questions referring dangerous substances and goods



Creation and modification of adhesives and composite panels in our Research and Development department

An overview of our range of products

Experience quality on a whole new level, with the powerful products by Weiss:



COSMO Adhesives

Durably firm joints

COSMO CA (Cyanoacrylates)
COSMO PU (Polyurethane adhesives)
COSMO CL (Cleaning agents)
COSMO SL (Dispersion adhesives)
COSMO HD (Hybrid adhesives)
COSMO EP (Epoxy-resin adhesives)
COSMO DS (Dispersion adhesives)
COSMO SP (Service products)

Fields of application

- + Windows and doors
- + Transportation / Marine engineering
- + Industry
- + Assembly
- + Dry construction
- + Airtight bonding
- + Wood / Furniture industry
- + Container construction
- + Composite panels
- + Fire protection
- + Advertising industry

Do you have any questions?

Our Service Center
Business area Adhesives:

+49 (0) 2773 / 815 - 255
+49 (0) 2773 / 815 - 274



COSMO Composite panels

Unlimited possibilities for design

COSMO Therm (heat-insulating)
COSMO Silent (sound insulating)
COSMO Protect (penetration resistant)
COSMO Design (grooved)
COSMO Tech (individual)
COSMO Frame (frame widening)

Fields of application

- + Window and façade
- + Door construction
- + Industry
- + Automotive manufacturing
- + Trailer construction
- + Partition panel construction
- + Gate construction
- + Container construction
- + Energy conservation
- + Fire protection
- + Burglar resistance
- + Sound proofing

Do you have any questions?

Our Service Center
Business Area Composite panels:

+49 (0) 2773 / 815 - 321

Our Service Center
Business area Façade:

+49 (0) 5245 / 9241 - 21



PUDOL Cleaning and care agent

Cleanliness refreshes your senses

PUDOL SOFT
Mild cleaning agent for sensitive materials
PUDOL CARE
Maintenance product for high gloss and hygiene
PUDOL POWER
Powerful cleaning agent for extreme pollution
PUDOL FRESH
Cleaning agent for cleanliness and fresh air

Fields of application

- + Flooring
- + Sanitary installations
- + Clothing care
- + Foodstuff industry
- + Household and gastronomy
- + Windows and glass
- + Dishwasher
- + Carpet and upholstery
- + Industry and workshop
- + Cars
- + Skin cleaning
- + Skin protection

Do you have any questions?

Our Service Center PUDOL:

+49 (0) 2743 / 9212 - 0



Plant I
Weiss Chemie + Technik
GmbH & Co. KG
Hansastr. 2
D-35708 Haiger

Phone: +49 (0) 2773 / 815 - 0
Fax: +49 (0) 2773 / 815 - 200
E-mail: ks@weiss-chemie.de

www.weiss-chemie.de

Plant II
Weiss Chemie + Technik
GmbH & Co. KG
Siemensstr. 8
D-33442 Herzebrock-Clarholz

Phone: +49 (0) 5245 / 9241 - 0
Fax: +49 (0) 02773-815-300
E-mail: se@weiss-chemie.de

PUDOL



*A subsidiary of the
Weiss Group*

Pudol Chemie GmbH & Co. KG
Bahnhofstr. 2
D-57520 Niederdreisbach

Phone: +49 (0) 2743 / 9212 - 0
Fax: +49 (0) 2743 / 9212 - 71
E-mail: info@pudol.de
www.pudol.de

Cleanliness refreshes your senses

made by weiss