

COSMO® Adhesives
Solutions for construction



Together to Success

A strong partner



Quality, service and high delivery reliability are the basic pillars of the success of our group of companies. We have continuously improved and further developed our portfolio in the last years; this also includes the acquisition of new companies. By now, about 325 employees at four sites participate in the success of our group.



Company

By pooling the core competences of our business segments of adhesives and composite panels under a single roof, we are able to offer solutions from one source to our customers that are efficient and of high technical quality.

We are among the leading manufacturers in these two business segments in Europe and moreover, we also increasingly sell our products outside of Europe, such as in China, Russia and the USA.

Company history

Since the company's foundation in 1815, Weiss has developed from a small glue producer to an internationally acting, industrial company for modern adhesive systems and composite panels. With a passion for quality and the aspiration to meet our customers' high expectations, we are a recognised and reliable partner on the market.

Powerful product range

Division Adhesives



Durably firm bond joints

Traditional joining technologies like riveting, soldering, welding, or screwing, will increasingly be replaced by modern adhesive systems, resulting in many advantages.

Our product range includes more than 400 variants of surface and construction adhesive and superglues, as well as special adhesives for a wide variety of applications.

Division Composite panels

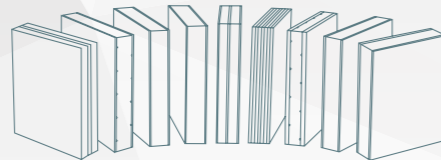

Unlimited possibilities for design

Our range of products includes more than 5,000 variants of composite panels. Because there is a large number of top coats and core materials available as well as the possibility of combining and processing them in many different ways, a vast number of creative designs results for the finished element.

PUDOL Cleaning and maintenance products



Cleanliness refreshes your senses

PUDOL stands for convincing quality of special products in the field of commercial cleaning. In addition to a complete range of cleaning and care products for different applications, we are offering a comprehensive service with interesting solutions and benefits.

A subsidiary of the Weiss Group

Weiss is the only enterprise that produces adhesives and composite panels.

Agenda

Weiss is offering highly loadable adhesive systems tailored to your special requirements in the field of **Airtight Bonding, Dry Construction and for the Flat Roof**. On the basis of our long-term experience in the building practice and the intensive exchange of experience with system providers, customers in industry and trade, and our cooperation in research groups we have continuously been enhancing our possible applications in the adhesive technology.



Certifications

Low-emission adhesives from Weiss

GEV-EMICODE®- licensed products

EMICODE® is a recognised standard for building products (incl. adhesives) promoting healthy living and is a quality label for the proof of low VOC-emissions. Products labelled with EMICODE® are modern, solvent-free, and low-emission building products. www.emicode.de



The "DIN-certified bio-based" label

A neutral and transparent quality label regarding the content of bio-based carbon and the product quality makes finding of resource-efficient products easier. By using the "DIN-certified bio-based" label, it is certified that we use bio-based raw materials and undergo regular monitoring. www.dincertco.de



8C092

Contribution for the all-around protected building envelope

Why is air- and windtight bonding required?

The topic of "Airtightness of the building envelope" has become more and more importance in the last years and this was not only because of the continuously rising energy costs and the increasing impact of environment. With this, the preservation of building stock also plays an important role, because this effectively prevents expensive repairs of structural damages.

The airtight building envelope...

 ... Provides long-term protection from structural damages!

 ...Reduces costs by saving energy.

 ...Provides for the preservation of the buildings.

 ...Meets future statutory provisions referring the building standard.

 ...Provides for healthy room climate.

 ...Improves the feelgood factor.

 ...Provides protection from mould fungi.

 ...Saves energy while reducing the CO₂ emission.

 ...Makes a contribution to climate change and climate objectives 2050.

Safety with COSMO® "Airtight Bonding"

10 reasons why you can trust in COSMO® "Airtight Bonding"

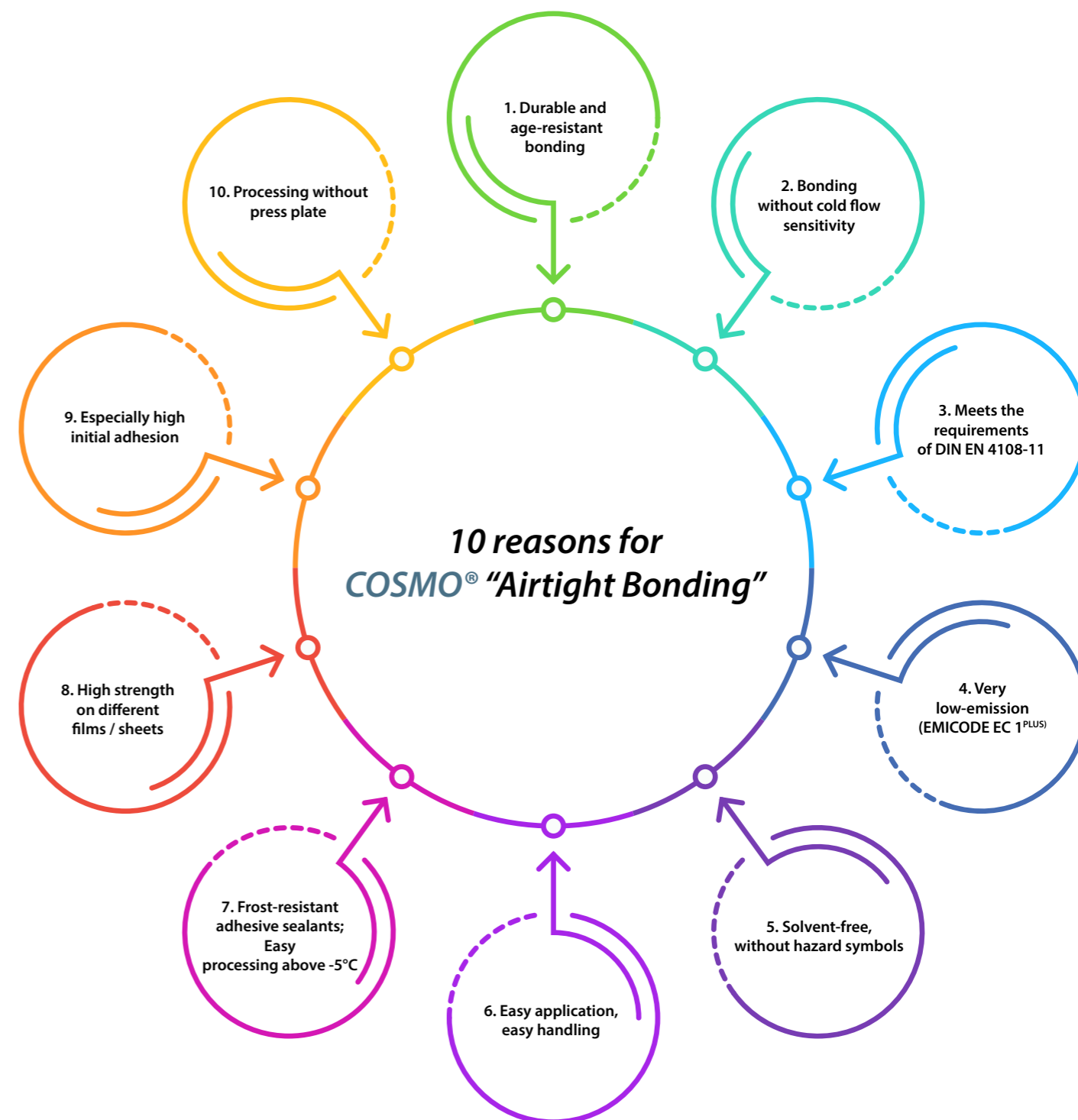

Airtight Bonding - outside

Our applications at a glance

Why is it required to make the buildings windtight from the outside?

The wind- and rain-safe building envelope protects the insulation from rain, snow, and wind on the outside. The materials used as underroof, underceiling, undertrussing and façade sheets, as well as for the sealing of the counter battens must durably be bonded in a wind- and rain-resistant way. Here, Weiss convinces by its compact product portfolio for the most diverse fields of application "around the roof" outdoors.

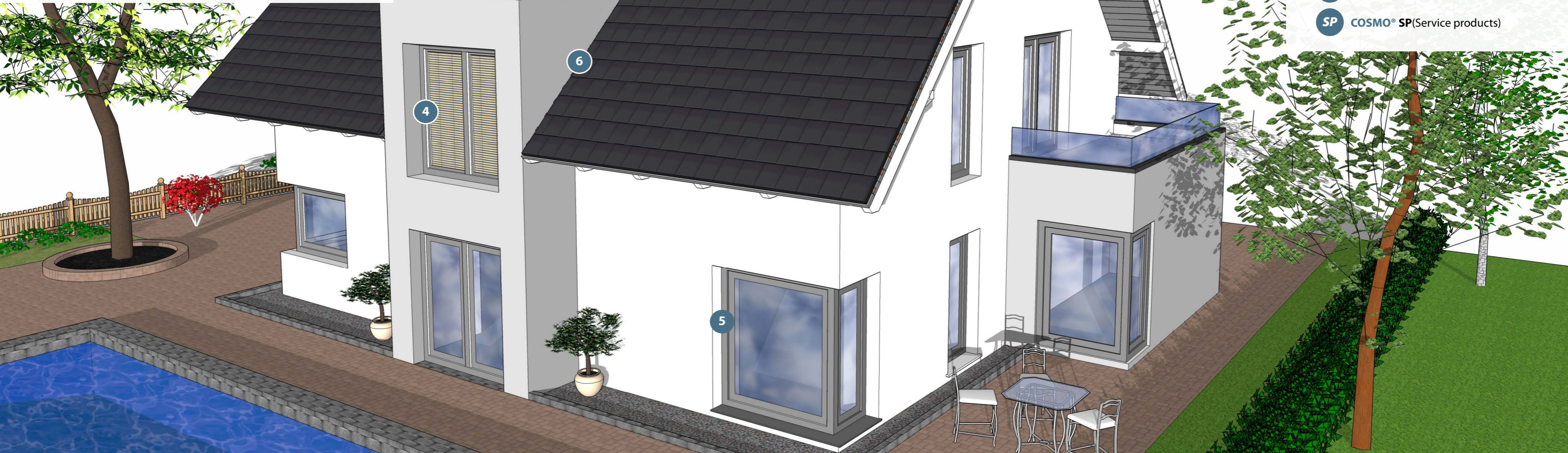

Product groups

- DS** COSMO® DS (Dispersion adhesives)
- HD** COSMO® HD (Hybrid adhesives)
- PU** COSMO® PU (Polyurethane adhesives)
- SL** COSMO® SL (Diffusion adhesives)
- SP** COSMO® SP (Service products)

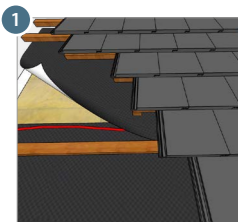

Overlapping bonding with e.g. **COSMO® PU-100.120**

1 Please find further information on page 8.

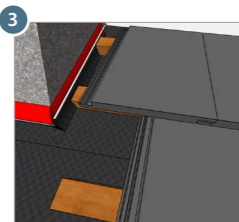

Bonding / sealing of roof underlays in the joint areas of chimneys with e.g. **COSMO® PU-100.120**

1 Please find further information on page 8.

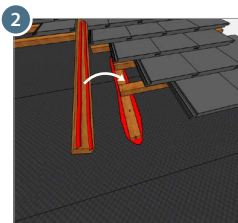

Flowable sealant for sealing of underroof, underceiling, undertrussing and façade sheets in the areas of nail staples / counter batten sealing with e.g. **COSMO® PU-160.230**

1 Please find further information on page 8.

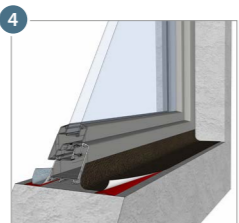

Pre-treatment of the substrate for self-adhesive joint tapes on window and door jambs with e.g. **COSMO® SP-830.180** for the RAL assembly

1 Please find further information on page 9.

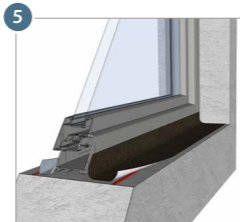

Bonding of the joint tapes on window and door jambs with e.g. **COSMO® HD-100.510** for the RAL assembly

1 Please find further information on page 9.

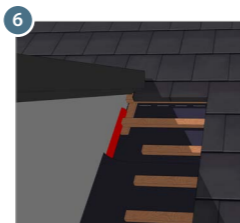

Bonding and sealing of roof underlays in the joint areas of dormers with e.g. **COSMO® HD-110.110**

1 Please find further information on page 9.

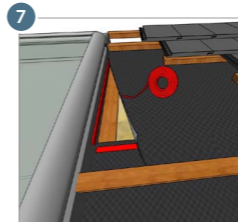

Bonding and sealing of roof underlays in the joint areas of roof windows with e.g. **COSMO® DS-450.110**

1 Please find further information on page 10.

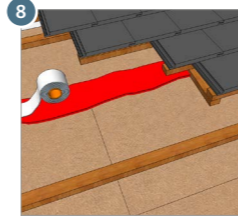

For adhesion promotion / improvement of the most diverse substrate materials with e.g. **COSMO® SP-830.180**

1 Please find further information on page 10.

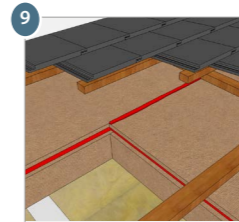

Sealing of bonded structural connections and joints in case of wood fibre insulation plates, e.g. **COSMO® HD-100.483**

1 Please find further information on page 10.

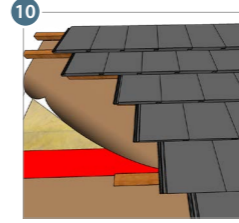

Bonding of connecting and overlapping joints of TPU-coated roof undertrussing and façade sheets, e.g. **COSMO® SL-680.120**

1 Please find further information on page 11.

Airtight bonding

Building envelope – outside

1 Adhesive sealant for bonding and sealing...

- For overlapping joints of underroof, underceiling, undertrussing and façade sheets

COSMO® PU-100.120

Special Properties:

- Optimum penetration characteristics in the fleece layer
- Interruption of fleece wick effect
- heat-resistant up to +120 °C

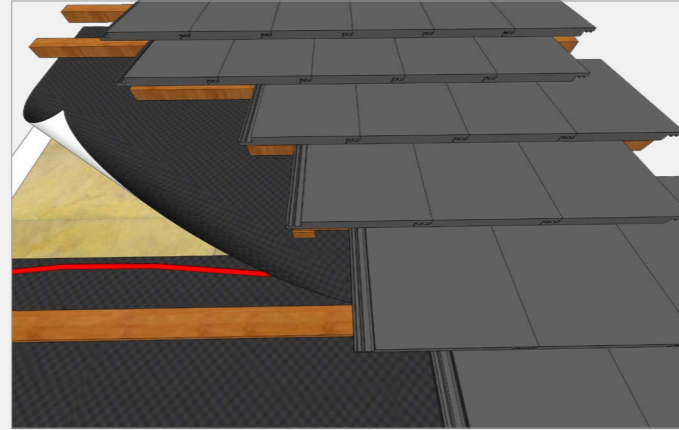

2 Flowable adhesive sealant for sealing...

- Of underroof, underceiling, undertrussing and façade sheets in the area of nail staples / counter batten sealing

COSMO® PU-160.230

Special Properties:

- Especially easy handling of dosing bottle
- Interruption of fleece wick effect
- Optimum penetration characteristics in the fleece layer

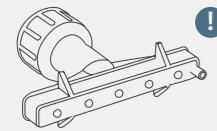
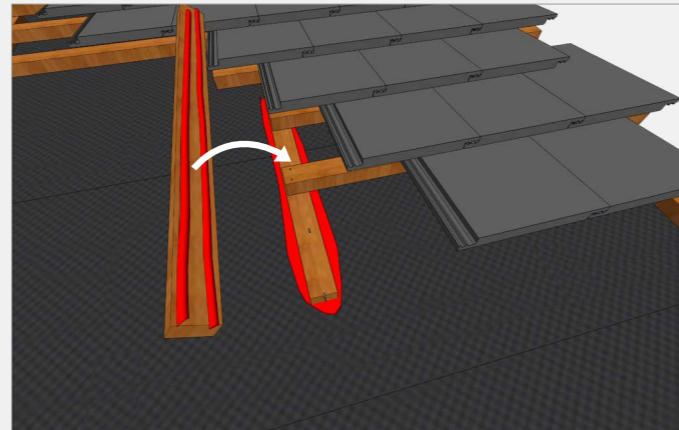

! The flat nozzle for adhesives and sealants COSMO® SP-810.510

The flat nozzles guarantee the homogeneous application of adhesive over a width of 20-75mm. Optimally adapted to 48 mm and 60 mm lathing.

3 Adhesive sealant for bonding and sealing...

- Of the connections on chimneys, walls, gables, roof-windows and dormers, etc.
- Of nails and staples in the area of the counter battens

COSMO® PU-100.120

Special Properties:

- Optimum penetration characteristics in the fleece layer
- Interruption of fleece wick effect
- heat-resistant up to +120 °C

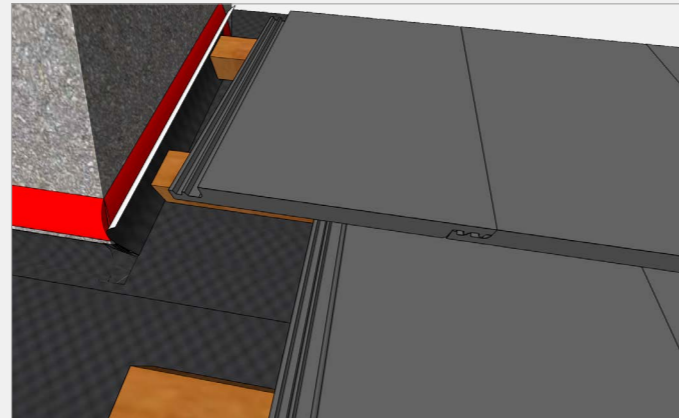

4 Primer / first coat...

- For preparing the substrate for self-adhesive joint tapes on window and door jambs – for the RAL assembly

COSMO® SP-830.180

Special Properties:

- Optimum preparation for the substrate material
- Strong bonding strength to the joint tape due to self-adhesive properties
- Short flash time
- Freeze-resistant



5 Adhesive sealant for assembly...

- For bonding of joint tapes on window and door jambs outside - for the RAL assembly

COSMO® HD-100.510

Special Properties:

- Compensates expansion of different materials
- Good weather resistance outdoors
- Freeze-resistant



6 Adhesive sealant for bonding and sealing...

- Of connections on dormers, chimneys, walls, gables and roof windows, etc.
- For overlapping joints of underroof, underceiling, undertrussing and façade sheets, vapour-proof barriers and diffusion barriers

COSMO® HD-110.110

Special Properties:

- Chemically curing adhesive for indoor and outdoor application
- Elastic, self-adherent adhesive joint
- Fast functional strength

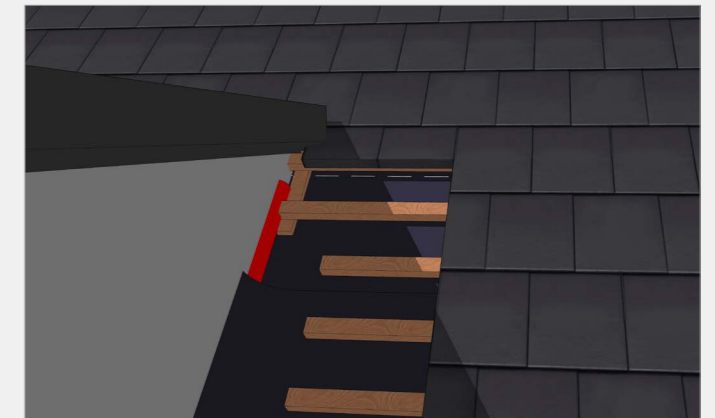
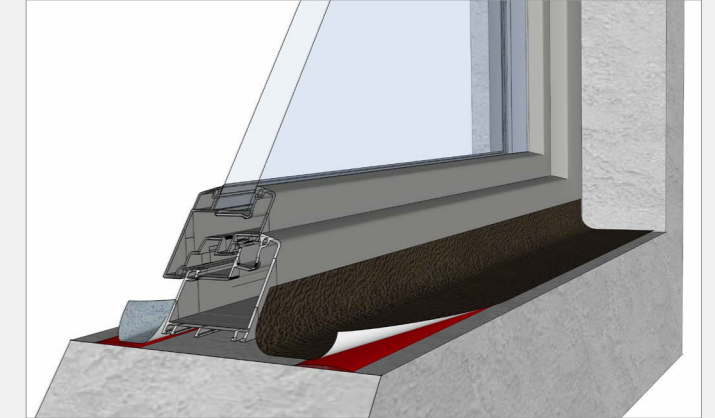

Airtight bonding

Building envelope – outside

7 PowerFilm: Adhesive on the roll for bonding and sealing...

- For connections to roof windows, dormers, chimneys, walls and gables, etc.
- For overlapping joints of underroof, underceiling, undertrussing and façade sheets, vapour-proof barriers and diffusion barriers

COSMO® DS-450.110

Special Properties:

- Can be processed easily, fast and cleanly
- No drying time required
- High initial adhesion

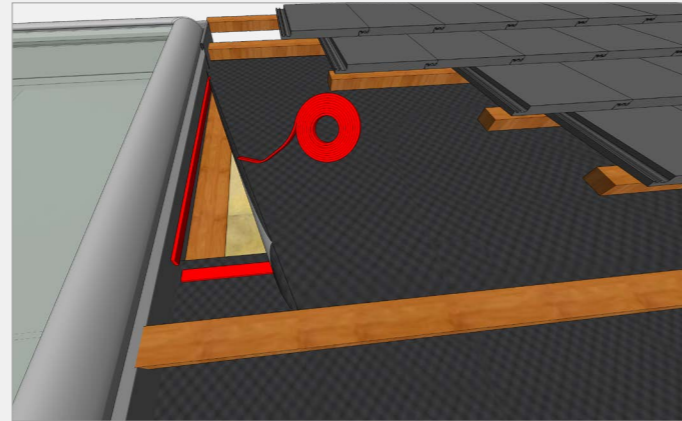

8 Primer / first coat...

- For adhesion promotion/improvement of acrylate, butyl and bitumen adhesive tapes on the most diverse absorbent substrate materials

COSMO® SP-830.180

Special Properties:

- Solvent-free, self-adhesive, strong depth effect
- Short flash time
- Good water resistance
- Freeze-resistant

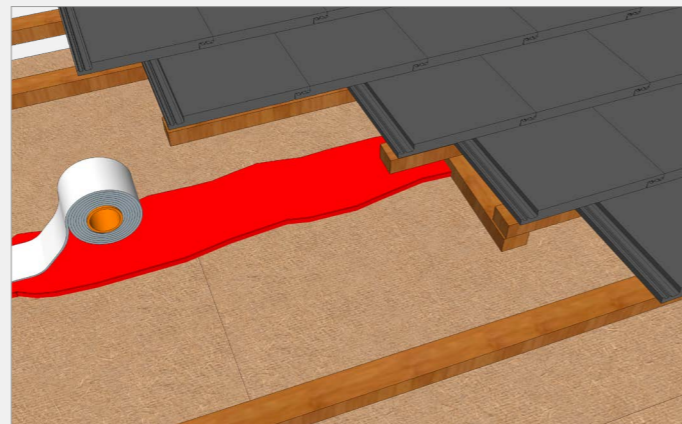

9 Adhesive sealant...

- For sealing of bonded structural connections and joints in case of insulating fibre boards
- For assembly and repair bonding

COSMO® HD-100.483

Special Properties:

- Joint-filling, not foaming
- Good weather-resistance
- Permanently elastic along with high strength

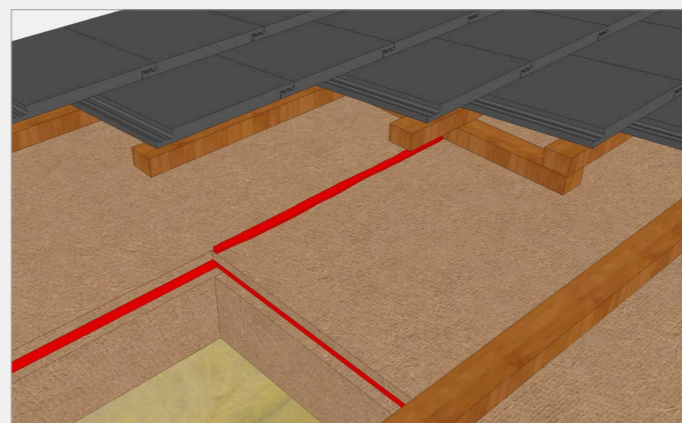

10 Adhesive sealant for bonding and sealing of TPU sheets...

- For overlapping joints of underroof, underceiling, undertrussing and façade sheets
- For connections to roof windows, dormers, chimneys, walls and gables, etc.
- as well as for sealing of cut edges

COSMO® SL-680.120

Special Properties:

- Very fast and high bonding strength with a wide range of application possibilities
- Overlapping / repair bonding and sealing of cut edges
- Bridges gaps

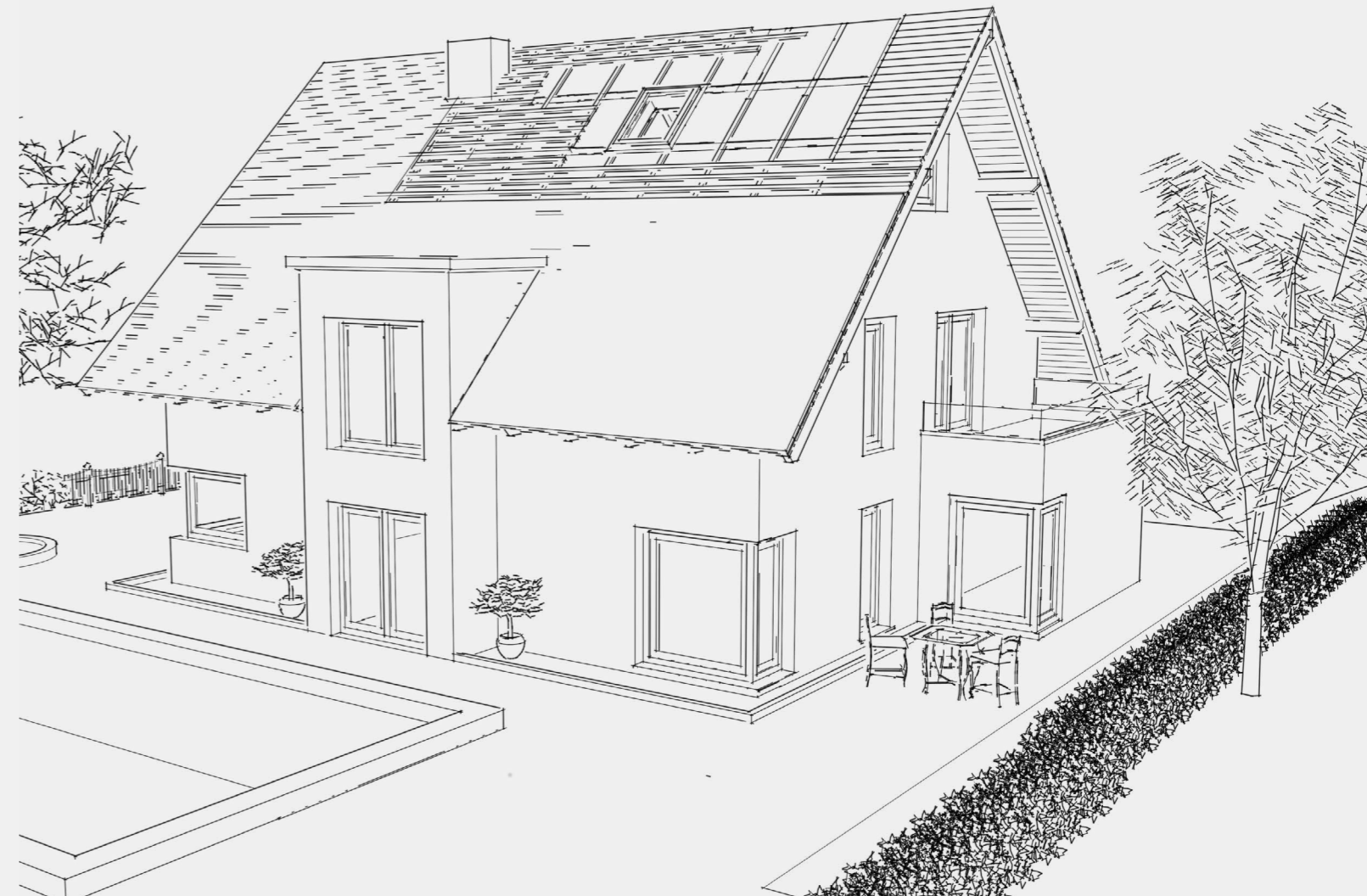
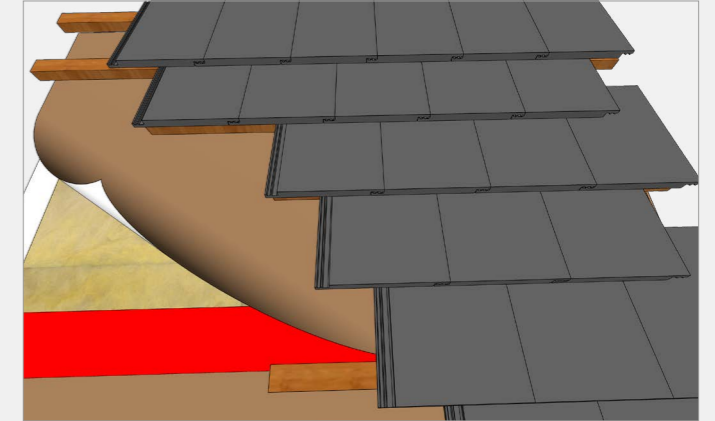

Airtight Bonding - Inside

Our applications at a glance

Why should the buildings be designed to be airtight inside?

The airtight layer protects the insulation from humidity inside the building. Furthermore, it contributes its share that the function of the heat insulation is optimally fulfilled and maintained. The materials used, like vapour checks and barriers, sealing films and window joint tapes have only an effect when they are safely and durably connected with the respective substrate material. The adhesives made by Weiss used here form such strong and durable, tight connections and in this way, they provide for the necessary safety.

Product groups

- DS** COSMO® DS (Dispersion adhesives)
- HD** COSMO® HD (Hybrid adhesives)
- SP** COSMO® SP (Service products)

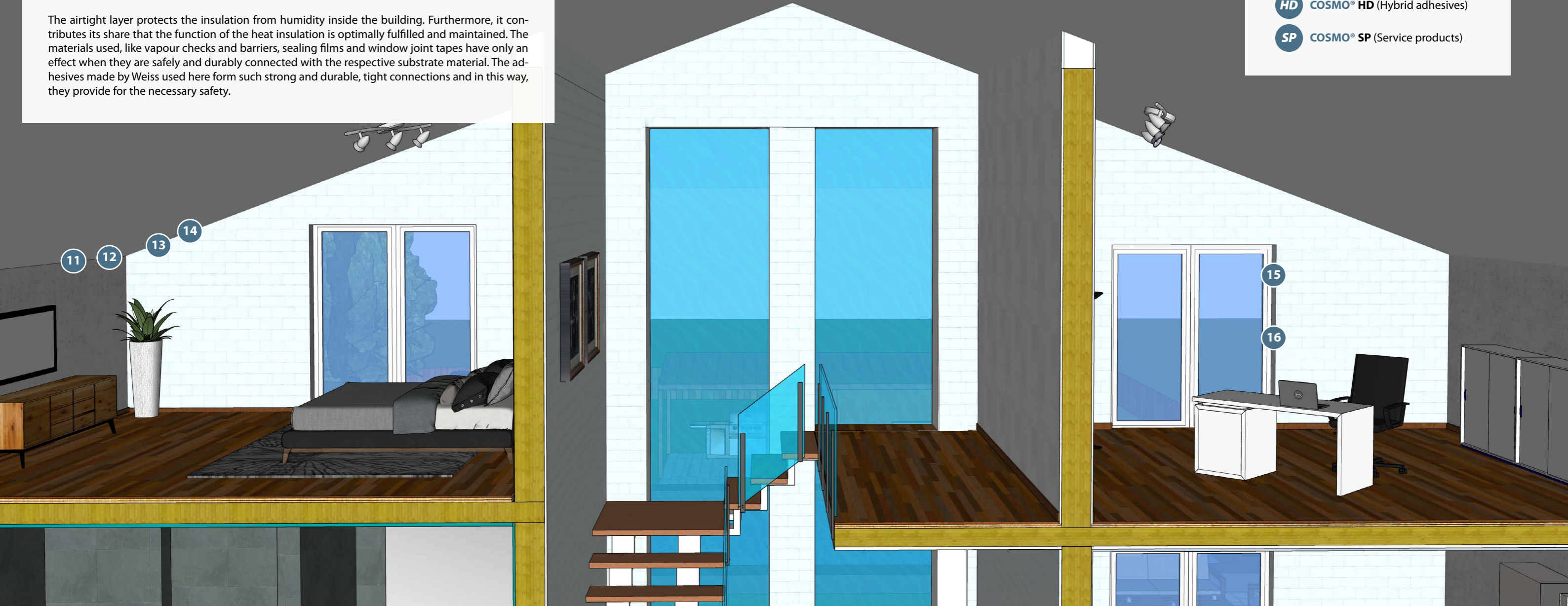

11

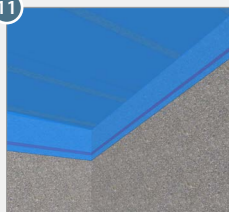

Connection bonding, e.g. with **COSMO® DS-420.240**, for vapour checks/barriers on, for instance, rough and mineral substrate material

! Please find further information on page 14.

13

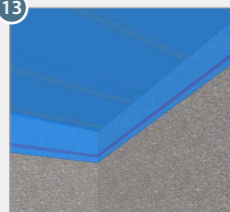

Connection bonding of vapour checks/barriers with, for instance, **COSMO® DS-450.110**, the **alternative adhesive on a roll!**

! Please find further information on page 14.

12

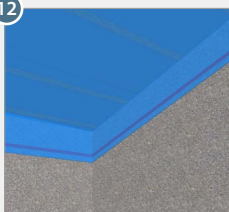

Connection bonding of vapour checks/barriers with, for instance, **COSMO® DS-470.900**, the **bio-based alternative!**

! Please find further information on page 14.

14

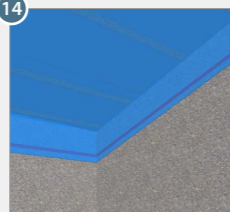

Connection bonding of vapour checks/barriers with, for instance, **COSMO® HD-110.110**, the **reactive alternative**

! Please find further information on page 14.

15

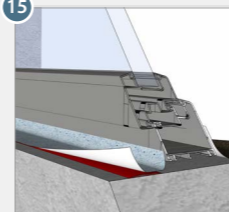

Pre-treatment of substrate for self-adhesive joint tapes on window and door jambs with, for instance, **COSMO® SP-830.180**, for RAL assembly as well as for adhesion promotion of acrylate, butyl and bitumen adhesive tapes on the most diverse absorbent substrate materials

! Please find further information on page 15.

16

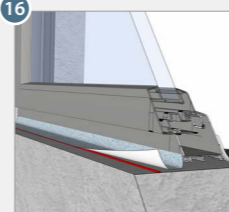

Bonding of joint tapes on window and door jambs inside with, for instance, **COSMO® DS-420.110**, for the RAL assembly

! Please find further information on page 15.

COSMO® BIOBASED

Our **bio-based adhesives** actively contribute to the protection of the environment: As innovative products, they have been developed with particular regard to our limited resources, without losing sight of the top quality that we take for granted.

In the meantime, there are numerous possibilities to process the most diverse bio-based materials, like starch, vegetable oil, resins, lignins, proteins, and others. It is possible to use renewable raw materials also in adhesives. By substituting fossil resources, we have succeeded in developing adhesives which contain a certain amount of bio-based products.

Airtight bonding

Building envelope – inside

11 Adhesive sealant for vapour barriers for bonding and sealing...

- Of the airtight connections of vapour barriers, vapour checks and sealing films on different building substrates

COSMO® DS-420.240

Special Properties:

- After curing self-adhesive, elastic adhesive joint
- High adhesive strength on different types of film
- Very high initial adhesion
- Meets the requirements as per EN 4108-11

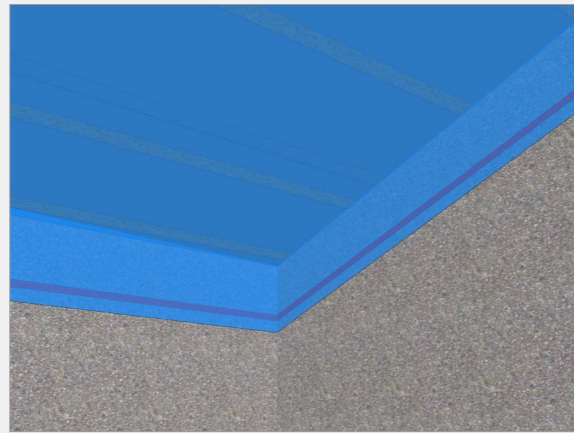

14 Reactive adhesive sealant for vapour barriers for bonding and sealing...

- Of the airtight connections of vapour barriers, vapour checks and sealing films on different building substrates

COSMO® HD-110.110

Special Properties:

- Chemically curing adhesive for indoor and outdoor application
- Elastic, self-adherent adhesive joint
- Fast functional strength

The reactive alternative!

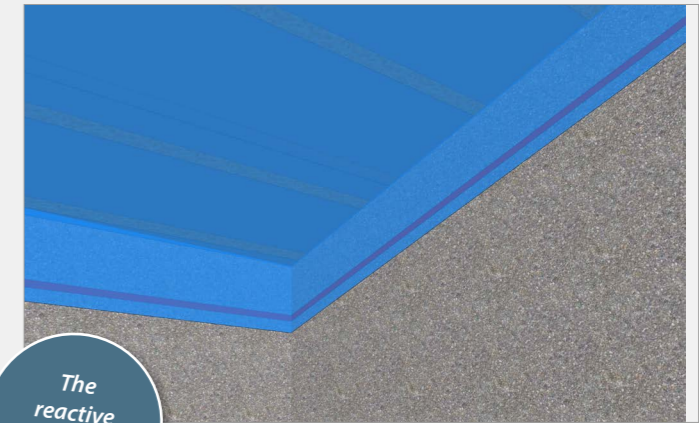

12 Adhesive sealant BIO-BASED for bonding and sealing...

- Of the airtight connections of vapour barriers, vapour checks and sealing films on different building substrates

COSMO® DS-470.900

Special Properties:

- Contains approx. 47% bio-based carbon content
- After curing self-adhesive, elastic adhesive joint
- High adhesive strength on different types of film
- Very high initial adhesion
- Meets the requirements as per EN 4108-11



8C092

The bio-based alternative!

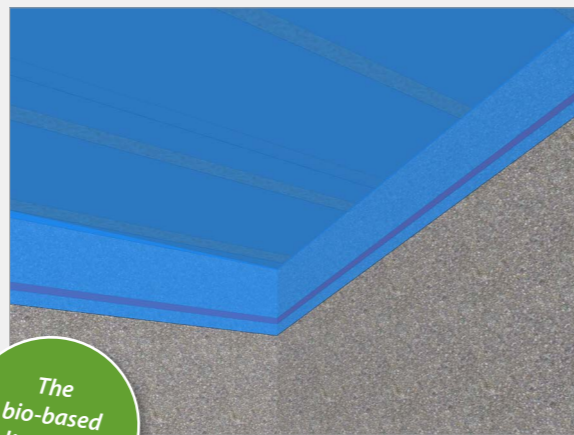

15 Primer / first coat

- For preparing the substrate for self-adhesive joint tapes on window and door jambs – for the RAL assembly
- For adhesion promotion/improvement of acrylate, butyl and bitumen adhesive tapes on the most diverse absorbent substrate materials

COSMO® SP-830.180

Special Properties:

- Optimum preparation for the substrate material
- Strong bonding strength to the joint tape due to self-adhesive properties
- Short flash time

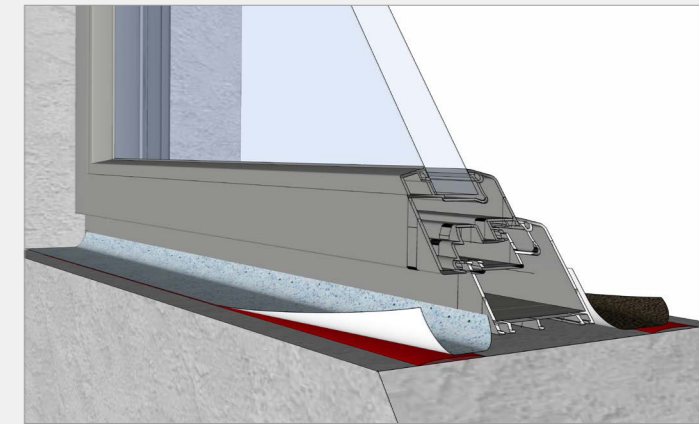

13 PowerFilm: Adhesive on the roll for bonding and sealing...

- Of the airtight connections of vapour barriers, vapour checks and sealing films on different building substrates

COSMO® DS-450.110

Special Properties:

- Can be processed easily, fast and cleanly
- No drying time required
- No cutting tool required



PowerFilm: The adhesive on the roll!

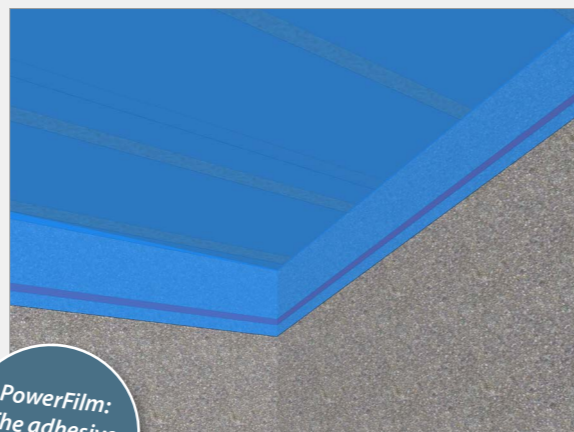

16 Adhesive sealant for assembly...

- For bonding of joint tapes on window and door jambs inside - for the RAL assembly:

COSMO® DS-420.110

Special Properties:

- High initial adhesion and functional strength
- Low shrinkage
- Joint-filling

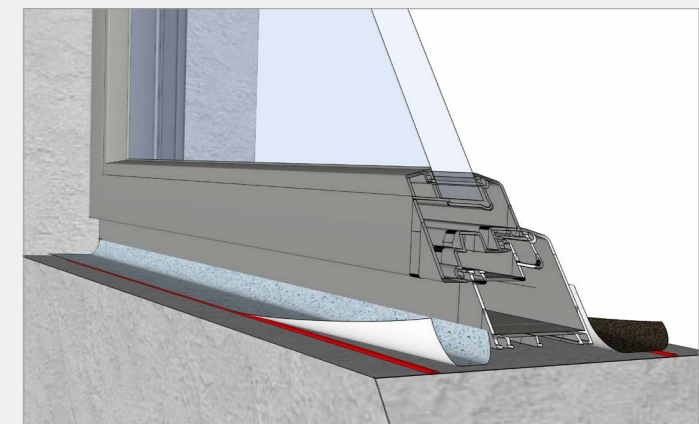

Airtight bonding

Our COSMO® adhesives by comparison

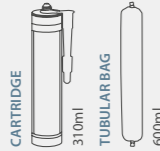
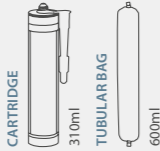
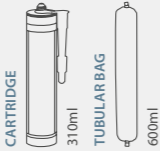
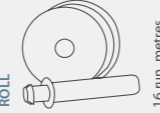
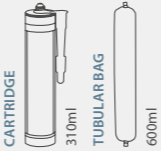
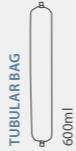
Product designation	 COSMO® DS-420.110	 COSMO® DS-420.240	 COSMO® DS-470.900 BIOBASED	 COSMO® DS-450.110 Powerfilm	 COSMO® HD-110.110	 COSMO® HD-100.510
Product	Vapour barrier - adhesive sealant	Vapour barrier - adhesive sealant	Vapour barrier - adhesive sealant	Adhesive	Adhesive sealant for vapour barriers/roof underlay sheets	Assembly adhesive sealant
Basis	DISPERSION	DISPERSION	DISPERSION	TPE	MS	STP
Application						
Vapour checks/barriers "inside area"	●	●	●	●	●	●
Joint tapes for window and door assembly "inside area"	●	●	●	●	●	●
Joint tapes for window and door assembly "outside area"	◐	◐	◐	●	●	●
Undertrussing sheets "Outside area"	◐	◐	◐	◐	●	◐
Façade webs "Outside area"	◐	◐	◐	●	●	◐

● Eminently suitable ◐ Limited suitability ○ Not suitable

Applications

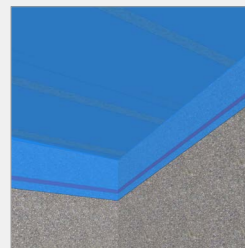

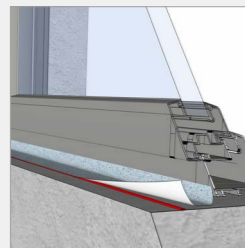

Vapour checks/barriers "inside area"

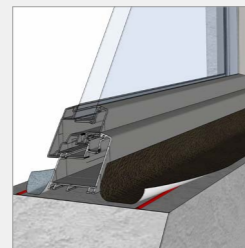

Joint tapes for window and door assembly "inside area"

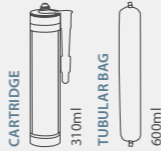
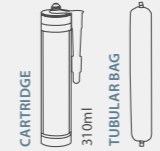

Joint tapes for window and door assembly "outside area"

Product designation	 COSMO® HD-100.483	 COSMO® PU-100.120	 COSMO® PU-160.230	 COSMO® SL-680.120
Product	Assembly adhesive sealant	Roof underlay - adhesive sealant	Nail sealant	TPU sealant
Basis	STP	PUR	PUR	TPU
Application				
Undertrussing sheets "Outside area"	○	●	○	●*
Façade webs "Outside area"	○	●	○	●*
Nail sealing "Outside area"	○	●	●	○
Sealing of cut edges "Outside area"	○	○	○	●*
Sealing of bonded structural connections and joints Wood fibre board "inside and outside"	●	●	○	○

* For TPU coated undertrussing and façade sheets.

● Eminently suitable ◐ Limited suitability ○ Not suitable

Applications

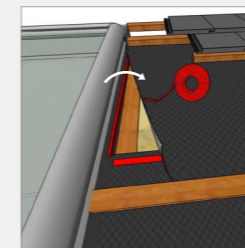

Undertrussing sheets "Outside area" (Example: roof window)

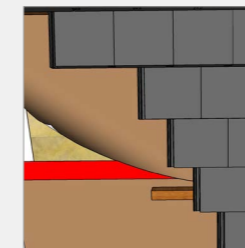

Façade webs "Outside area"

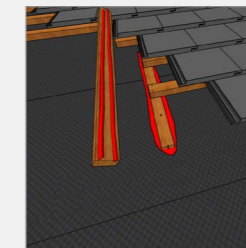

Nail sealing "Outside area"

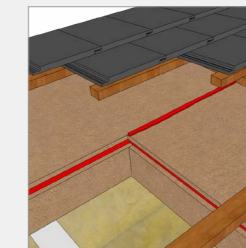

Sealing of bonded structural connections and joints
Wood fibre board "inside and outside"

Dry construction

Applications at a glance

Today, flexibility with the construction of new buildings and pre-engineered houses, but also for refurbishment measures and the professional finishing and completion of flats, business rooms and offices always plays a more and more important role. We are offering suitable adhesive systems for large number of applications in the field of dry construction.

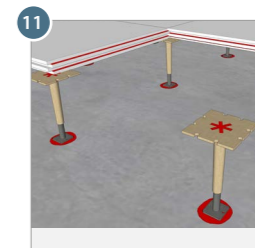

System floors:
1. Bonding of cross-joints.
2. Bonding of supports on unfinished floors.
3. Thread lock of threaded struts
Please find further information on page 24.

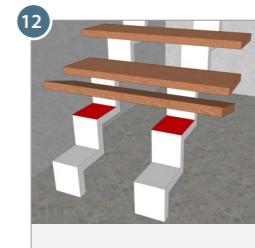

Bonding of step elements on substructures in the field of stair construction and for stair refurbishment
COSMO® PU-200.180
COSMO® PU-200.910
Please find further information on page 25.

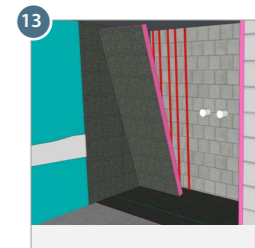

Wet room: Bonding of building boards on ceilings, walls and substructures
COSMO® HD-100.400
COSMO® HD-100.480
Please find further information on page 25.

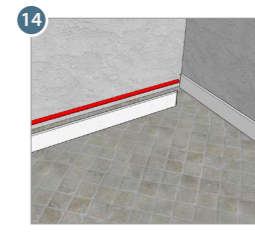

Bonding of decorative strips and skirtings on walls
COSMO® PU-100.110
COSMO® HD-100.480
Please find further information on page 26.

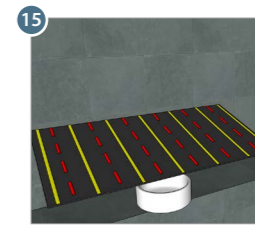

Bonding of mirrors as per technical regulations of the glaziers' trade
COSMO® HD-100.400
Please find further information on page 26.

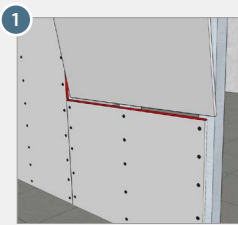

Bonding of structural connections/joints of drywall plates when installing walls
COSMO® PU-100.380
COSMO® HD-100.200
Please find further information on page 20.

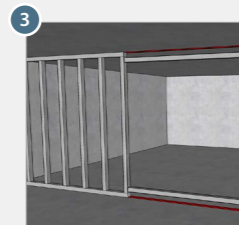

Bonding of substructures on ceilings and floors
COSMO® HD-100.800
Please find further information on page 20.

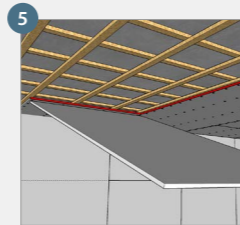

Bonding of cross-joints of drywall plates when installing them on ceilings
COSMO® PU-100.380
COSMO® HD-100.200
Please find further information on page 22.

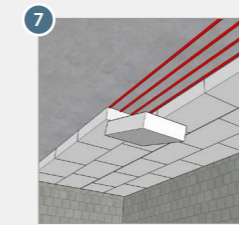

Bonding of insulating materials on ceilings (e.g. on basement ceilings during refurbishment)
COSMO® HD-100.800
Please find further information on page 22.

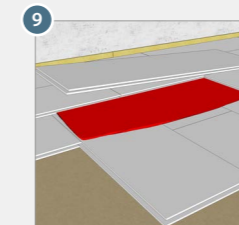

Doubling of floor elements
COSMO® PU-160.300
COSMO® PU-100.260
Please find further information on page 23.

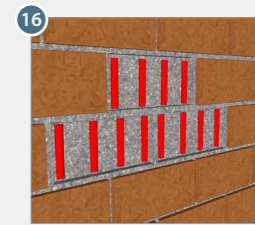

Refurbishment of clinker brick façades
COSMO® PU-200.280
Please find further information on page 26.

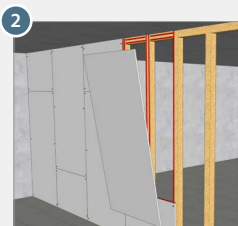

Bonding of drywall plates on substructures
COSMO® PU-100.380
COSMO® HD-100.200
Please find further information on page 20.

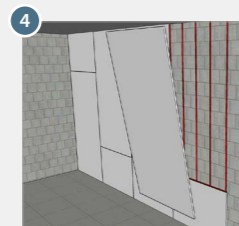

Bonding of drywall plates on already existing walls
COSMO® PU-100.380
COSMO® HD-100.200
COSMO® HD-100.800
Please find further information on page 21.

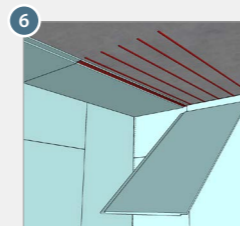

Bonding of drywall plates on the ceiling
COSMO® HD-100.800
Please find further information on page 22.

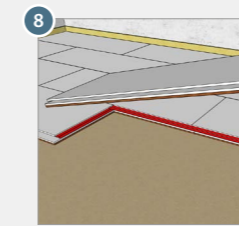

Bonding of cross-joints, stepped rabbets joints of floor elements
COSMO® PU-160.120
COSMO® PU-160.310
COSMO® DS-400.190
Please find further information on page 23.

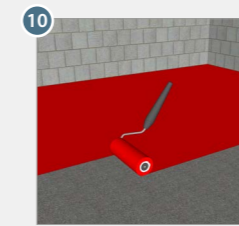

Sealing of unfinished floors
COSMO® DS-440.160
Please find further information on page 23.

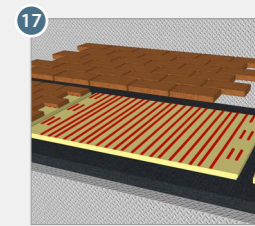

Industrial construction of clinker brick façades in the field of pre-fabricated construction
COSMO® PU-200.171
COSMO® PU-220.900
COSMO® HD-100.400
COSMO® HD-100.800
Please find further information on page 27.

Dry construction

Bonding applications on walls

1 Bonding of structural connections/joints of drywall plates (gypsumfibre boards) when installed on walls

COSMO® PU-100.380

Special Properties:

- Semi-hard adhesive joint
- Good adhesion characteristics to several types of wood and building material, ceramics and metals
- Joint-filling

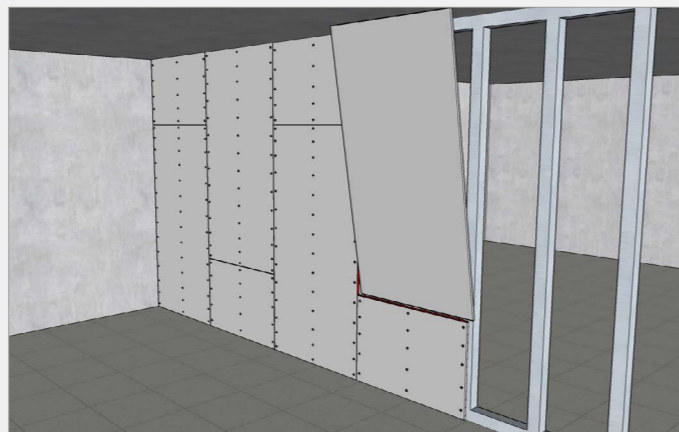

COSMO® HD-100.200

Special Properties:

- elastic adhesive joint
- High strength of adhesive joint
- Solvent-free
- Not foaming



2 Bonding of drywall plates on already existing walls on substructures

COSMO® PU-100.380

Special Properties:

- Semi-hard adhesive joint
- Good adhesion characteristics to several types of wood and building material, ceramics and metals
- Joint-filling

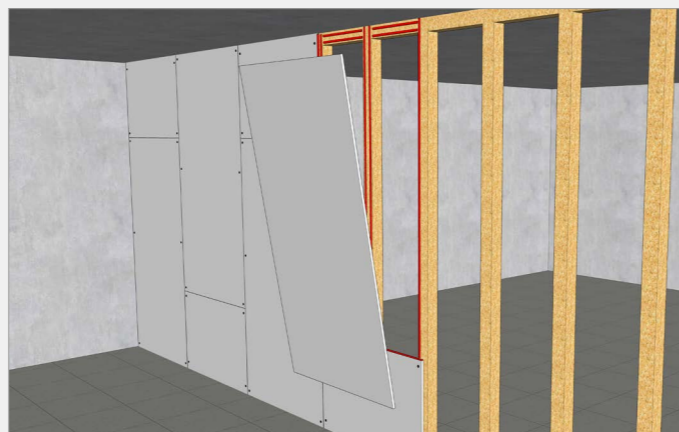

COSMO® HD-100.200

Special Properties:

- elastic adhesive joint
- High strength of adhesive joint
- Solvent-free
- Not foaming



3 Bonding of substructures on ceilings and floors

COSMO® HD-100.800

Special Properties:

- High Tack
- elastic adhesive joint
- Particularly fast reaction time
- Fast touch force for assembly works
- Very good application possibilities

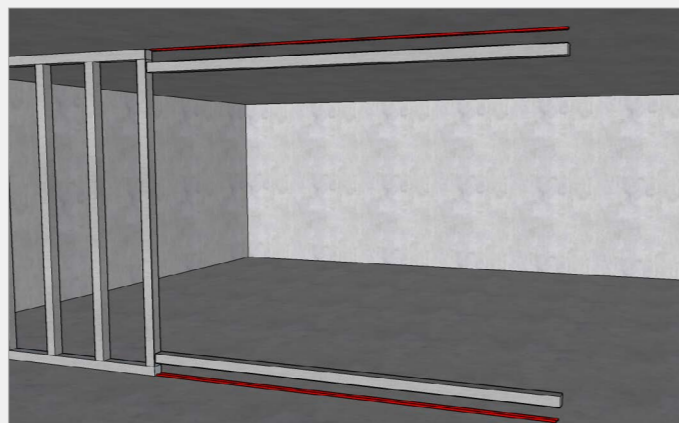

4 Bonding of drywall plates on already existing walls

COSMO® PU-100.380

Special Properties:

- Semi-hard adhesive joint
- Good adhesion characteristics to several types of wood and building material, ceramics and metals
- Joint-filling

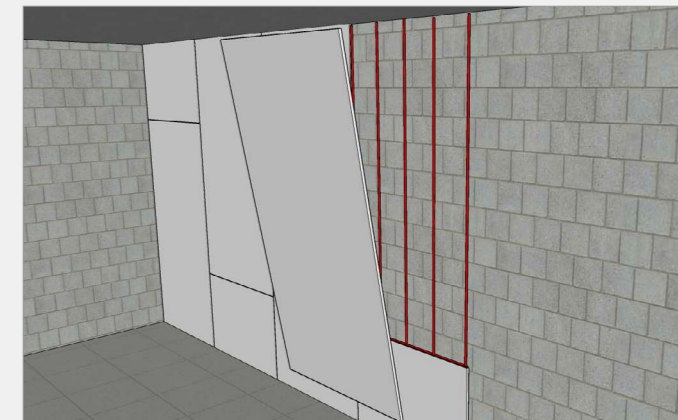

COSMO® HD-100.200

Special Properties:

- elastic adhesive joint
- High strength of adhesive joint
- Solvent-free
- Not foaming



COSMO® HD-100.800

Special Properties:

- High Tack
- elastic adhesive joint
- Particularly fast reaction time
- Fast touch force for assembly works
- Very good application possibilities



Dry construction

Bonding applications - ceiling & floor

5 Bonding of cross-joints of drywall plates when installing them on ceilings

COSMO® PU-100.380

Special Properties:

- Semi-hard adhesive joint
- Good adhesion characteristics to several types of wood and building material, ceramics and metals
- Joint-filling

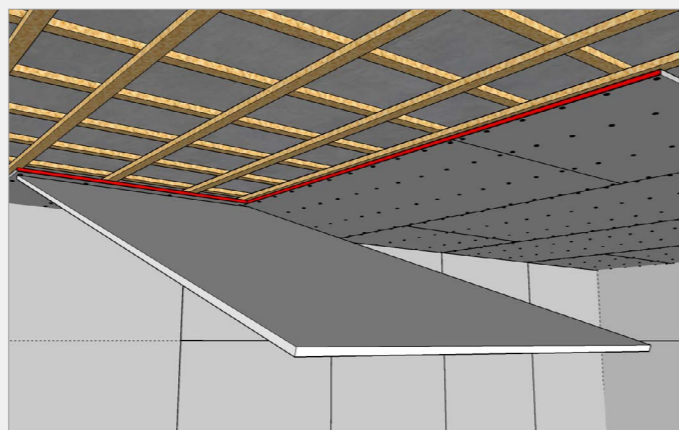

COSMO® HD-100.200

Special Properties:

- elastic adhesive joint
- High strength of adhesive joint
- Solvent-free
- Not foaming



6 Bonding of drywall plates on the ceiling

COSMO® HD-100.800

Special Properties:

- High Tack
- elastic adhesive joint
- Particularly fast reaction time
- Fast touch force for assembly works
- Very good application possibilities

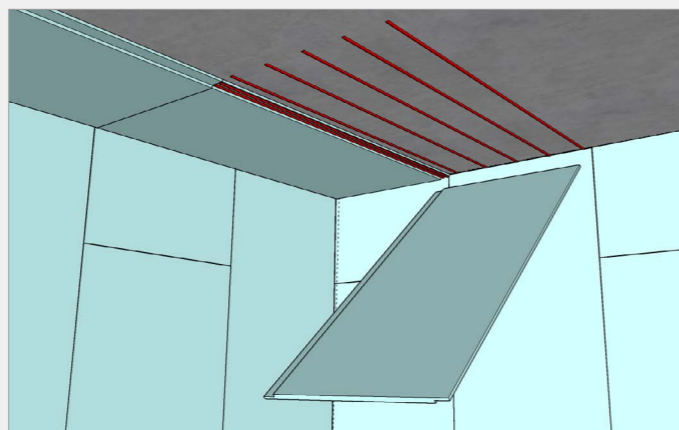

7 Bonding of insulating materials on ceilings (e.g. on basement ceilings during refurbishment)

COSMO® HD-100.800

Special Properties:

- High Tack
- elastic adhesive joint
- Particularly fast reaction time
- Fast touch force for assembly works
- Very good application possibilities

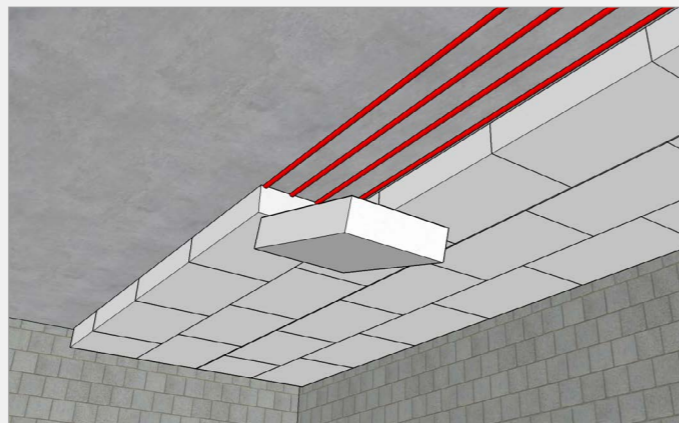

8 Bonding of cross-joints, grooves and rabbet joints of floor elements, e.g., made of MDF, laminate and gypsum fibres

COSMO® PU-160.120

Special Properties:

- Tough-hard adhesive joint
- Especially long open time

COSMO® PU-160.310

Special Properties:

- Tough-elastic adhesive joint
- Wide range of application on various materials

COSMO® DS-400.190

Special Properties:

- tough-elastic adhesive joint
- The hardened adhesive joints can be sanded

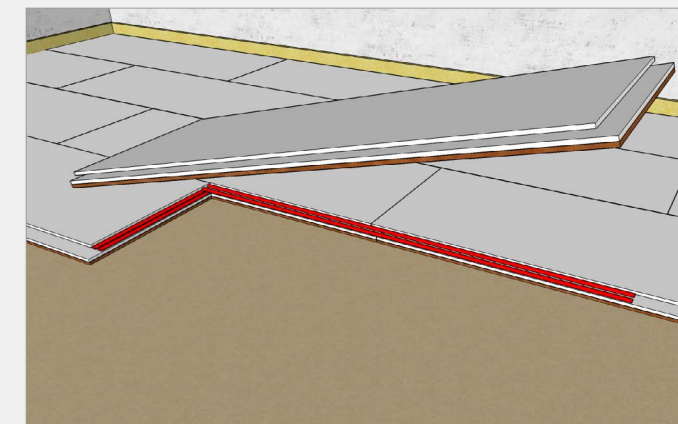

9 Doubling of floor elements

COSMO® PU-160.300

Special Properties:

- tough-elastic adhesive joint
- Good adhesion characteristics to different materials

COSMO® PU-100.260

Special Properties:

- Semi-hard adhesive joint
- Joint-filling
- Long open time

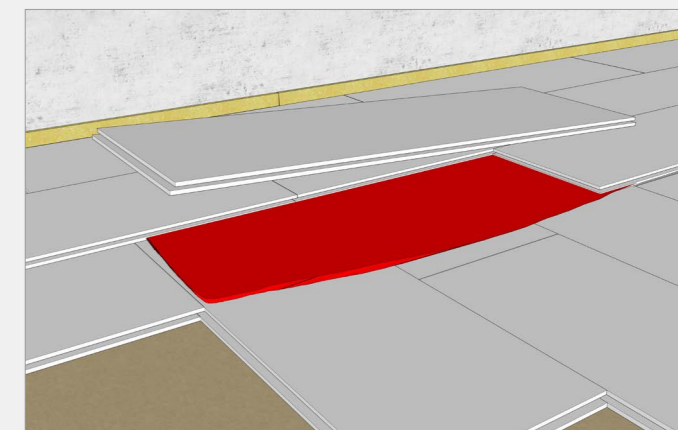

10 Sealing of unfinished floors

COSMO® DS-440.160

Special Properties:

- Dust binding
- Fast drying
- Water dilutable

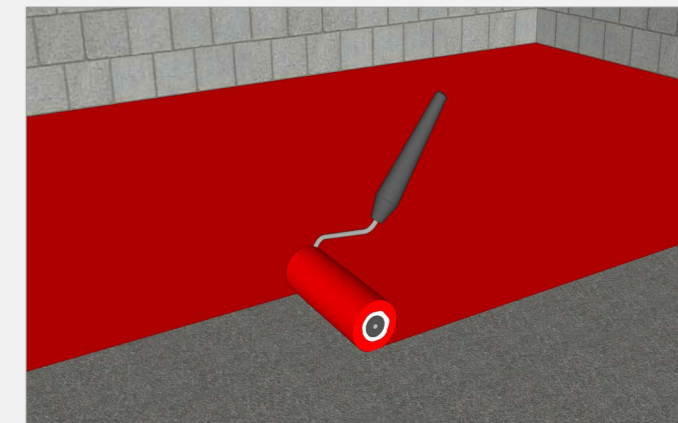

Dry construction

Bonding applications on floors, stairs and in wet rooms

11 1. Bonding of cross-joints of system floors

COSMO® PU-100.260

Special Properties:

- Semi-hard adhesive joint
- Joint-filling
- Long open time

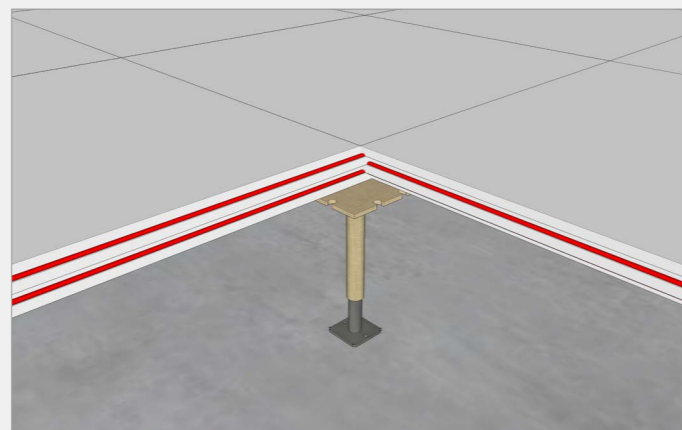

COSMO® PU-100.380

Special Properties:

- Semi-hard adhesive joint
- Good adhesion characteristics to several types of wood and building material, ceramics and metals
- Joint-filling



11 2. Fixation of supports of system floors

COSMO® PU-100.110

Special Properties:

- tough-elastic adhesive joint
- Joint-filling
- Particularly fast reaction time
- Fast and homogeneous, full hardening

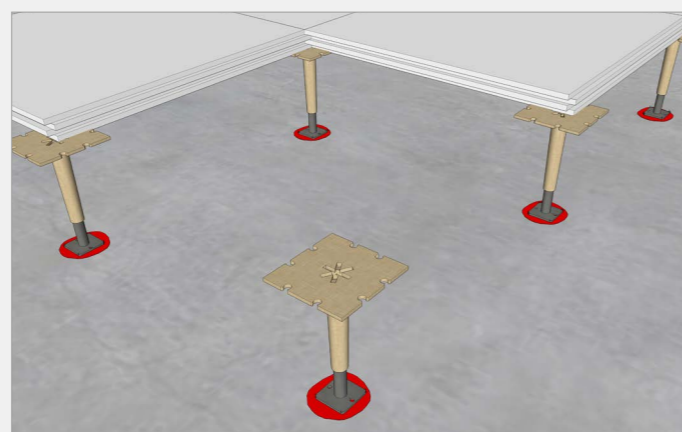

COSMO® HD-100.480

Special Properties:

- elastic adhesive joint
- Good adhesion characteristics to different surfaces
- Compensates the expansion of different materials

11 3. Thread locks of adjustable feet made of V2A, aluminium and galvanized steel for the assembly of system floors

COSMO® DS-440.150

Special Properties:

- tough-elastic adhesive joint
- Good bonding strength at heat



12 Bonding of step elements on substructures in the field of stair construction and for stair refurbishment

COSMO® PU-200.180

Special Properties:

- tough-elastic adhesive joint
- Good adhesion characteristics to different materials

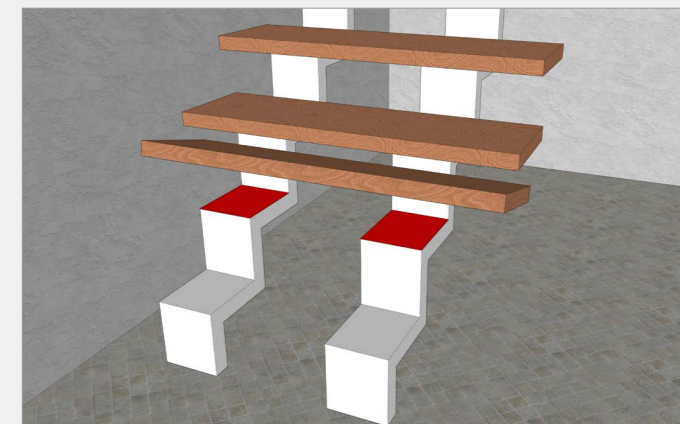

COSMO® PU-200.910

Special Properties:

- Bio-based on sustainable raw materials (approx. 67 % bio-based carbon content)
- tough-elastic adhesive joint
- Good adhesion characteristics to different materials



8C269

13 Bonding of building boards on ceilings, walls and substructures in wet rooms

COSMO® HD-100.400

Special Properties:

- elastic adhesive joint
- High strength of adhesive joints
- Compensates the expansion of different materials



COSMO® HD-100.480

Special Properties:

- elastic adhesive joint
- Good adhesion characteristics to different surfaces
- Compensates the expansion of different materials

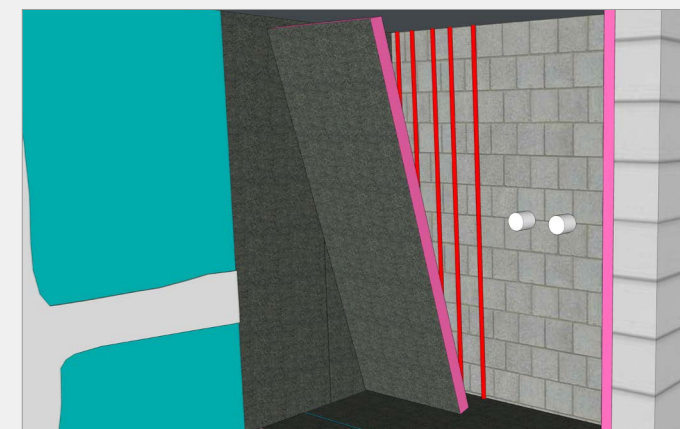

Dry construction

Bonding applications for battens, mirrors and clinker brick façades

14 Bonding of decorative strips and skirtings on walls

COSMO® PU-100.110

Special Properties:

- tough-elastic adhesive joint
- Joint-filling
- Particularly fast reaction time
- Fast and homogeneous, full hardening

COSMO® HD-100.480

Special Properties:

- elastic adhesive joint
- Good adhesion characteristics to different surfaces
- Compensates the expansion of different materials

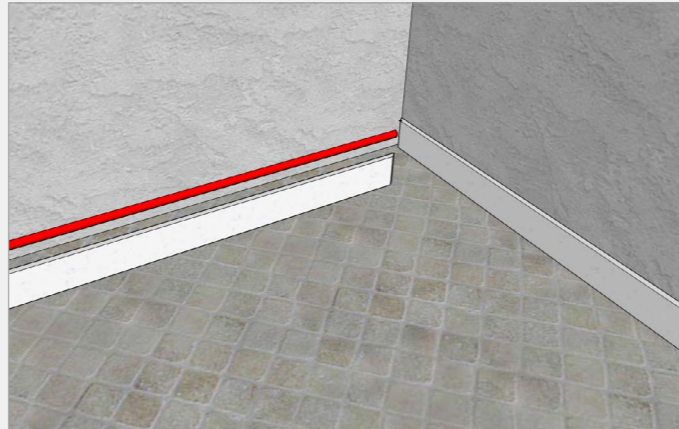

15 Bonding of mirrors as per technical regulations of the glaziers' trade

COSMO® HD-100.400

Special Properties:

- elastic adhesive joint
- High strength of adhesive joints
- Compensates the expansion of different materials

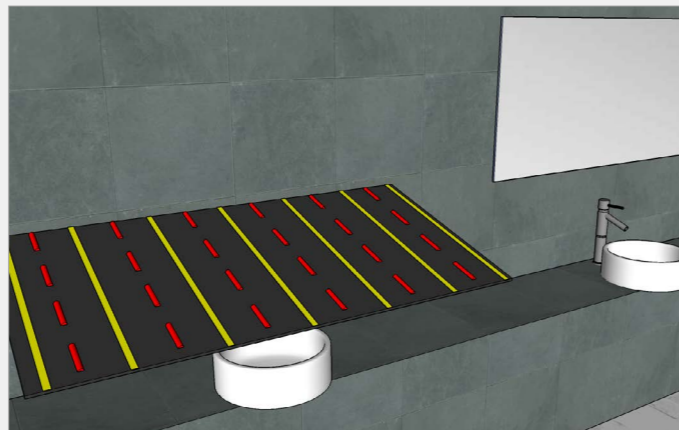

16 1. Refurbishment of clinker brick façades

COSMO® PU-200.280

Special Properties:

- Tough-hard adhesive joint
- Thixotropic, does not drop off
- Good weather-proofness
- Can be over-coated with many paint systems
- Also available as variant that does not need any hazard identification **COSMO® PU-200.350**

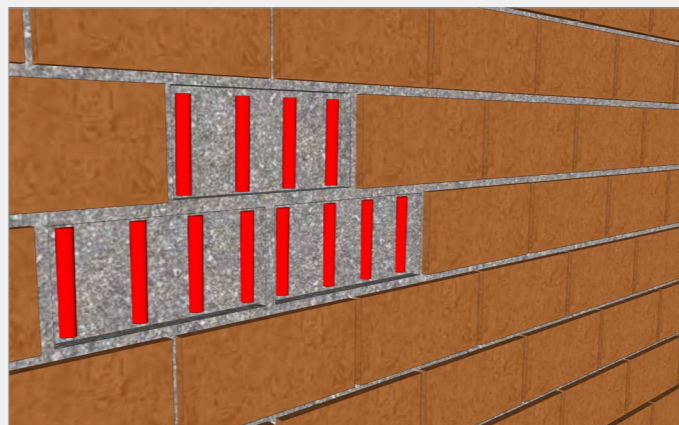

17 2. Industrial construction of clinker brick façades in the field of pre-fabricated construction

COSMO® PU-200.171

Special Properties:

- tough-elastic adhesive joint
- Thixotropic, does not drop off
- Good weather-proofness

COSMO® PU-220.900

Special Properties:

- Bio-based on sustainable raw materials (approx. 60 % bio-based carbon content)
- Very low emission*
- tough-elastic adhesive joint
- Good weather-proofness
- Good adhesion characteristics to different material surfaces like PVC-hard, GRP, aluminium, coloured glass, HPL etc. on diverse insulating materials, e.g. PUR-, PS-foam and mineral wool after appropriate pre-treatment of the surfaces



COSMO® HD-100.400

Special Properties:

- elastic adhesive joint
- High strength of adhesive joints
- Compensates the expansion of different materials



COSMO® HD-100.800

Special Properties:

- High Tack
- elastic adhesive joint
- Particularly fast reaction time
- Fast touch force for assembly works
- Very good application possibilities

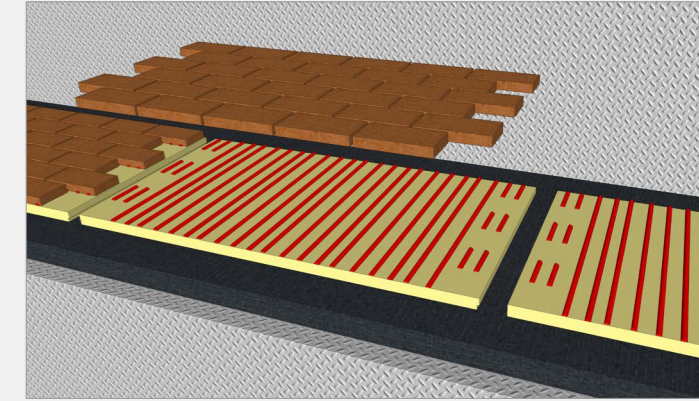

Cleaning of adhesive application machines with

COSMO® CL-300.220

Special Properties:

- Also dissolves partially cured/cured adhesives
- Very economical
- Intensive cleaning effect

Dry construction

Our COSMO® adhesives by comparison

COSMO® PU-100.380	1	2	4	5				11										
COSMO® HD-100.200	1	2	4	5														
COSMO® HD-100.800			3	4	6	7												17
COSMO® PU-220.900																		17
COSMO® PU-160.120							8											
COSMO® PU-160.310							8											
COSMO® DS-400.190							8											
COSMO® PU-160.300								9										
COSMO® PU-100.260								9	11									
COSMO® DS-440.160									10									
COSMO® PU-100.110										11	14							
COSMO® HD-100.480										11	13	14						
COSMO® DS-440.150										11								
COSMO® PU-200.180											12							
COSMO® PU-200.910											12							
COSMO® HD-100.400												13	15	17				
COSMO® PU-200.280														16				
COSMO® PU-200.171																		17

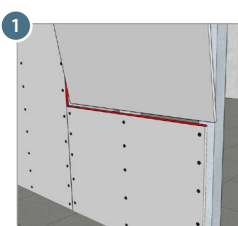

1 Bonding of structural connections/joints of drywall plates when installing walls
COSMO® PU-100.380
COSMO® HD-100.200
 Please find further information on page 20.

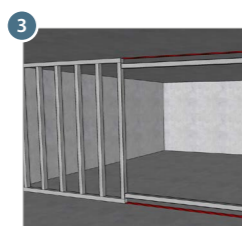

3 Bonding of substructures on ceilings and floors
COSMO® HD-100.800
 Please find further information on page 20.

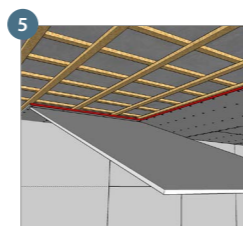

5 Bonding of cross-joints of drywall plates when installing them on ceilings
COSMO® PU-100.380
COSMO® HD-100.200
 Please find further information on page 22.

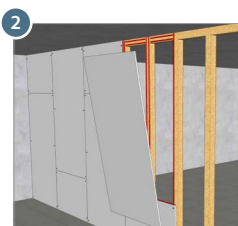

2 Bonding of drywall plates on substructures
COSMO® PU-100.380
COSMO® HD-100.200
 Please find further information on page 20.

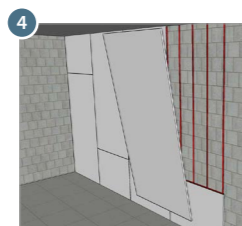

4 Bonding of drywall plates on already existing walls
COSMO® PU-100.380
COSMO® HD-100.200
COSMO® HD-100.800
 Please find further information on page 21.

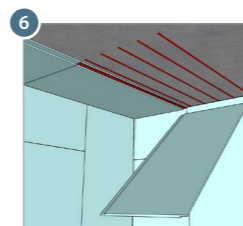

6 Bonding of drywall plates on the ceiling
COSMO® HD-100.800
 Please find further information on page 22.

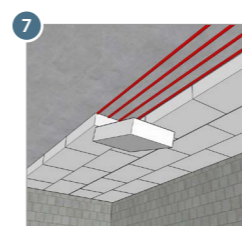

7 Bonding of insulating materials on ceilings (e.g. on basement ceilings during refurbishment)
COSMO® HD-100.800
 Please find further information on page 22.

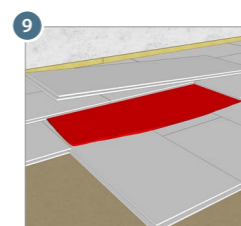

9 Doubling of floor elements
COSMO® PU-160.300
COSMO® PU-100.260
 Please find further information on page 23.

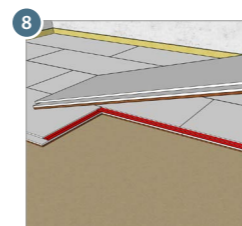

8 Bonding of cross-joints, stepped rabbets joints of floor elements
COSMO® PU-160.120
COSMO® PU-160.310
COSMO® DS-400.190
 Please find further information on page 23.

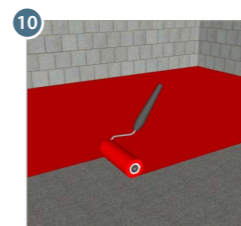

10 Sealing of unfinished floors
COSMO® DS-440.160
 Please find further information on page 23.

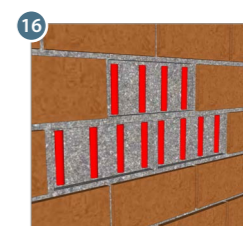

16 Refurbishment of clinker brick façades
COSMO® PU-200.280
 Please find further information on page 26.

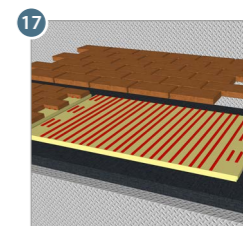

17 Industrial construction of clinker brick façades in the field of pre-fabricated construction
COSMO® PU-200.171
COSMO® PU-220.900
COSMO® HD-100.400
COSMO® HD-100.800
 Please find further information on page 27.

Designation	COSMO® PU-100.380	COSMO® HD-100.200	COSMO® HD-100.800	COSMO® PU-220.900	COSMO® PU-160.120
Product	Assembly adhesive	Assembly adhesive	Assembly adhesive	Reaction adhesive	Assembly adhesive
Basis	PUR	STP	STP	PUR	PUR
Designation	COSMO® PU-160.310	COSMO® DS-400.190	COSMO® PU-160.300	COSMO® PU-100.260	COSMO® DS-440.160
Product	Surface adhesive	Joint adhesive	Surface adhesive	Assembly adhesive	Unfinished floor sealing
Basis	PUR	PVAc dispersion	PUR	PUR	Acrylate polymer dispersion
Designation	COSMO® PU-100.110	COSMO® HD-100.480	COSMO® DS-440.150	COSMO® PU-200.180	COSMO® PU-200.910
Product	Assembly adhesive	Assembly adhesive	Special dispersion	Reaction adhesive	Reaction adhesive
Basis	PUR	STP	Acrylate polymer dispersion	PUR	PUR
Designation	COSMO® HD-100.400	COSMO® PU-200.280	COSMO® PU-200.171		
Product	MS-adhesive	Reaction adhesive	Reaction adhesive		
Basis	STP	PUR	PUR		

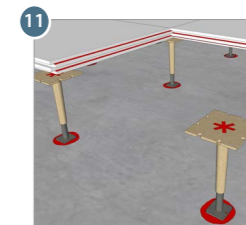

11 System floors:
 1. Bonding of cross-joints.
 2. Bonding of supports on unfinished floors.
 3. Thread lock of threaded struts
 Please find further information on page 24.

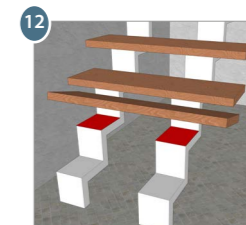

12 Bonding of step elements on substructures in the field of stair construction and for stair refurbishment
COSMO® PU-200.180
COSMO® PU-200.910
 Please find further information on page 25.

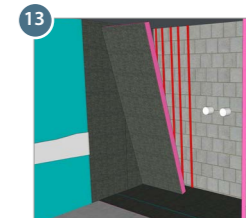

13 Wet room: Bonding of building boards on ceilings, walls and substructures
COSMO® HD-100.400
COSMO® HD-100.480
 Please find further information on page 25.



14 Bonding of decorative strips and skirtings on walls
COSMO® PU-100.110
COSMO® HD-100.480
 Please find further information on page 26.

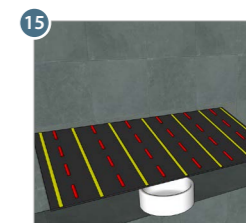

15 Bonding of mirrors as per technical regulations of the glaziers' trade
COSMO® HD-100.400
 Please find further information on page 26.

Flat roof

Our applications at a glance

Flat roof architecture is growing more and more not only for industrial halls but also for housing construction of one- or two-family houses. Visually attractive, with added value in the area of high-rise housing construction, such properties not only enjoy popularity in the urban area but also in the rural area. That, especially for this architectural style, particular attention is directed on detailed design is no coincidence, considering the possible long-term effect of humidity for such structures.

Weiss is offering numerous types of adhesive and cleaning solutions for this market segment.

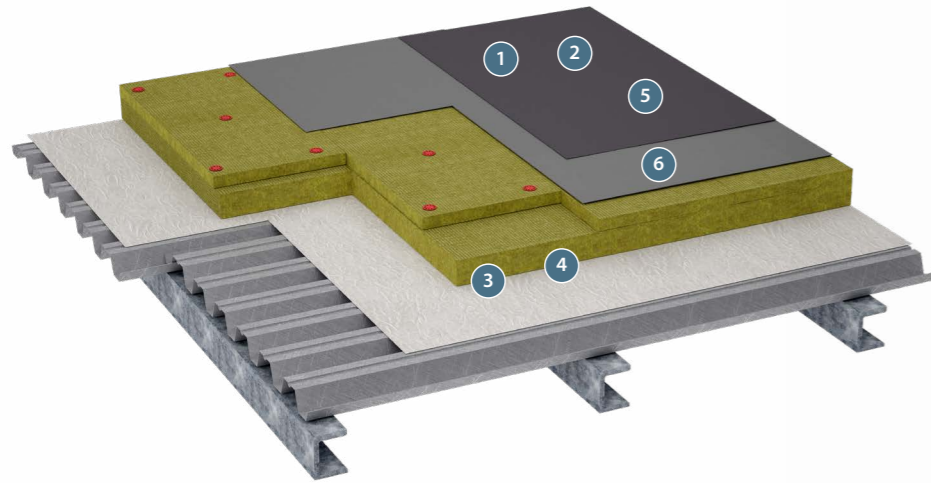

Product groups

- CL** COSMO® CL (cleaner & activators)
- HD** COSMO® HD (Hybrid adhesives)
- PU** COSMO® PU (Polyurethane adhesives)
- SL** COSMO® SL (Diffusion adhesives)
- SP** COSMO® SP (Service products)

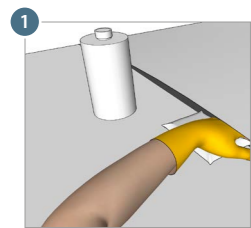

1 Pre-treatment for welding of roofing sheets made of PVC and FPO-/TPO by means of the cleaning agents **COSMO® CL-300.120** and **COSMO® CL-300.330**. The cleaners provide for a homogeneous and safe welding result by hot-air drier.

! Please find further information on page 32.

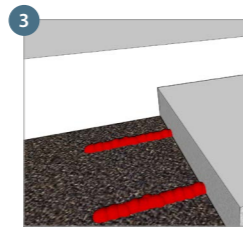

3 Bonding of insulating materials (mineral wool, PUR-, PS-foam) on different bituminous roofing sheets (sanded, slaty, etc.) as well as PVC sheets with fleece on different insulating materials (mineral wool, PUR-, PS foam) using the roof-sheet adhesive **COSMO® PU-160.640**

! Please find further information on page 32.

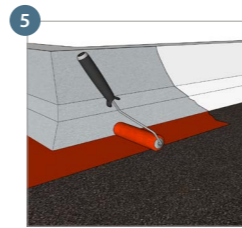

5 Coating mass for horizontal and conditionally vertical surfaces indoors and outdoors, e.g. rain gutters, pipe sleeves, cracks in roofs, walls and floors, complex connections of details, other components, surface bonding with **COSMO® HD-120.140**

! Please find further information on page 33.

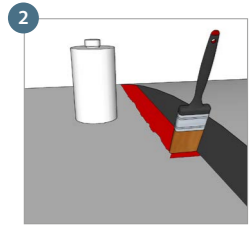

2 Welding of plastic roofing sheets using the solvent welding agent **COSMO® SL-640.110**

! Please find further information on page 32.

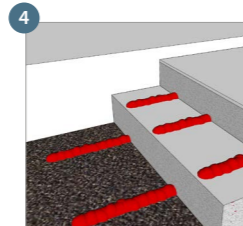

4 Bonding of insulating materials for roofs, e.g. polyurethane and phenolic-resin hard-foam, mineral wool and polystyrene, (EPS and XPS). Filling of cavities between individual heat insulation elements using the adhesive for insulating materials **COSMO® PU-160.110**

! Please find further information on page 33.

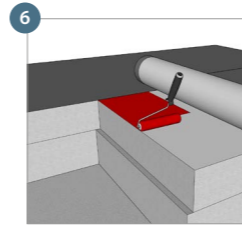

6 Adhesion promotion/improvement of acrylate, butyl and bitumen adhesive tapes, as well as self-adhesive plastic sheets on various substrates with primers **COSMO® SP-830.171** and **COSMO® SP-830.180**

! Please find further information on page 33.

Flat roof

Cleaning, welding, bonding & adhesion promotion

1 Cleaner for the pre-treatment of welded connections of...

- PVC and FPO-/TPO roofing sheets

COSMO® CL-300.120

Special Properties:

- Especially suitable for PVC roofing sheets
- Slightly dissolving
- Fast drying
- Good pre-treatment for subsequent welding of the PVC roofing sheets with each other

COSMO® CL-300.330

Special Properties:

- Especially suitable for FPO-/TPO roofing sheets
- Slight solvating/activation
- Good pre-treatment for subsequent welding of the FPO/TPO roofing sheets with each other

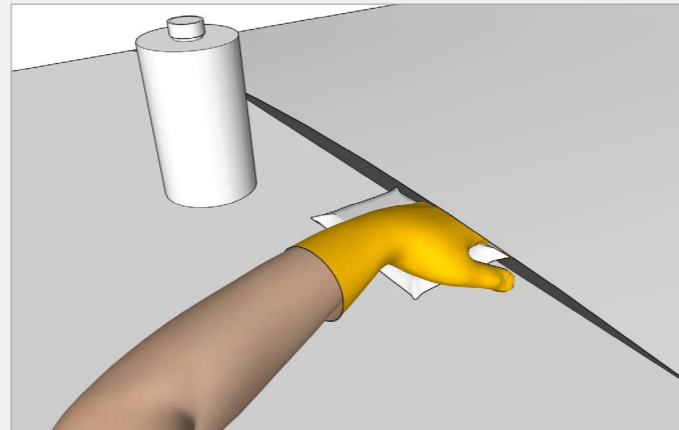

2 Solvent welding agent

- Plastic roofing sheets

COSMO® SL-640.110

Special Properties:

- Undetachable seam joint
- Short reaction time for welding

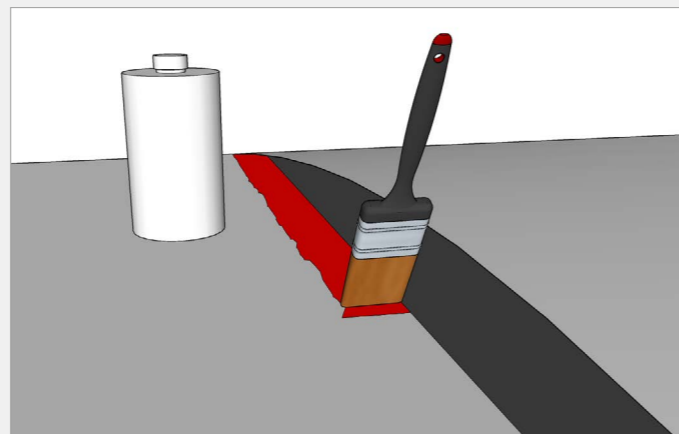

3 Roofing sheet adhesive for bonding of...

- Insulating materials (mineral wool, PUR-, PS-foam) on different bituminous roofing sheets (sanded, slaty, etc.)
- PVC sheets laminated with fleece on different insulating materials (mineral wool, PUR-, PS foam)

COSMO® PU-160.640

Special Properties:

- tough-elastic adhesive joint
- Solvent-free
- Good adhesion characteristics to several types of roof substrates/building materials, e.g. bitumen felt, stone, concrete, wood, diverse metals, as well as on diverse insulating materials like PUR-, PS-foam and mineral wool

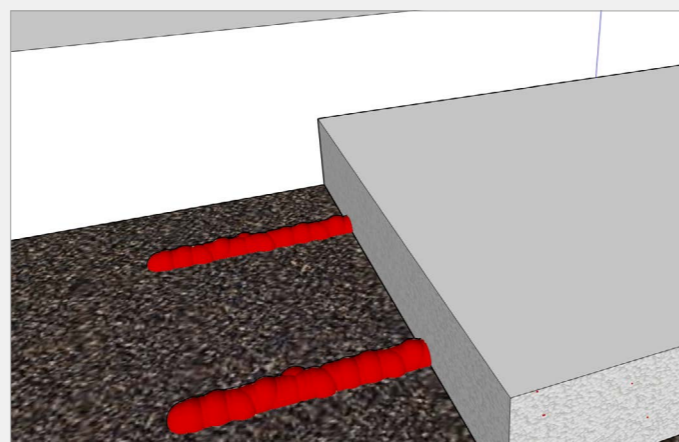

4 Insulating material adhesive for bonding of...

- Insulating materials for roofs, e.g. polyurethane and phenolic-resin hard-foam, mineral wool and polystyrene, (EPS and XPS), as well as for filling of cavities between individual heat insulation elements

COSMO® PU-160.110

Special Properties:

- tough-elastic adhesive joint
- Solvent-free
- Good adhesion characteristics to several types of roof substrates/building materials, e.g. bitumen felt, stone, concrete, wood, diverse metals, as well as on diverse insulating materials like PUR-, PS-foam and mineral wool

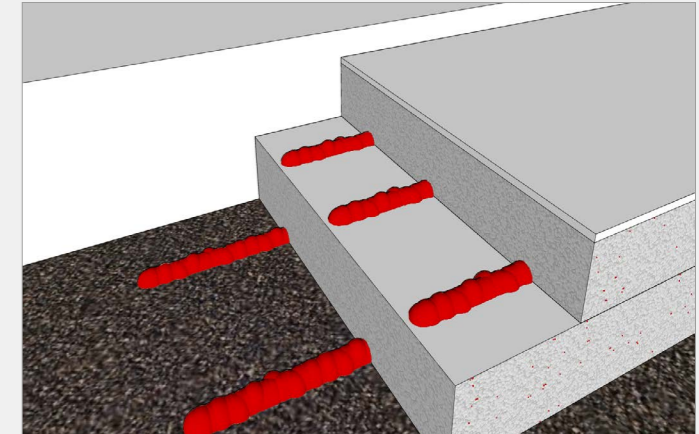

5 Coating mass for...

- Horizontal and conditionally vertical surfaces indoors and outdoors, e.g. rain gutters, pipe sleeves, cracks in roofs, walls and floors, complex connections of details, other components, surface bonding

COSMO® HD-120.140

Special Properties:

- Self-levelling
- Permanently elastic adhesive joint
- Can be coated repeatedly
- Good UV-stability
- Solvent-free

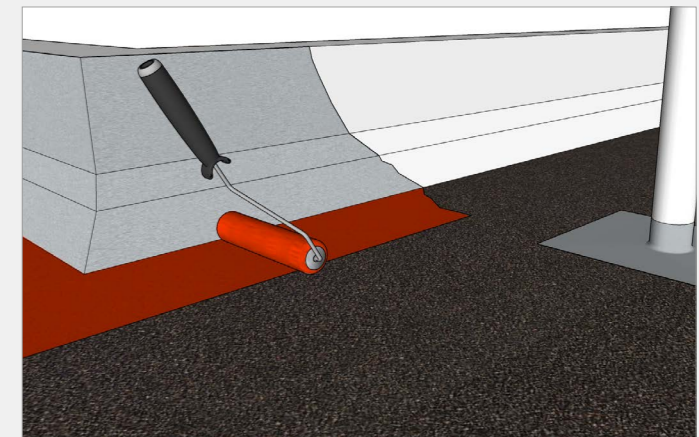

6 Primer for adhesion promotion/improvement of...

- Acrylate, butyl and bitumen adhesive tapes

COSMO® SP-830.171

Special Properties:

- Also suitable for self-adhesive plastic sheets
- Suitable for various absorbent mineral substrates, as well as non-absorbent substrates like insulating boards
- Colour changes by hardening
- Forms a smooth, not long-term adhesive film after curing
- Solvent-free, freeze-resistant and short flash time



COSMO® SP-830.180

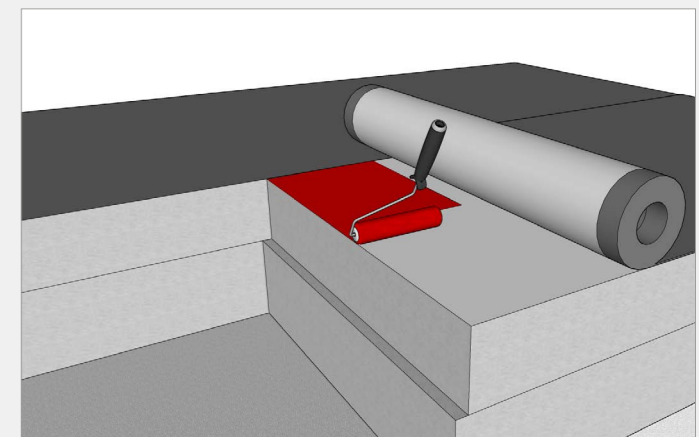

Special Properties:

- For different types of absorbent mineral substrates like cement and gypsum fibre boards, concrete, stone, brick and lime sand brick masonry, fibrous substrates of soft fibre boards (natural, hydrophobic and bituminized), wood materials, wood (planed or raw sawn) and building materials that are generally suitable.
- Forms a smooth, long-term adhesive film after curing
- Solvent-free and freeze-resistant

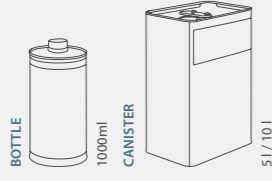
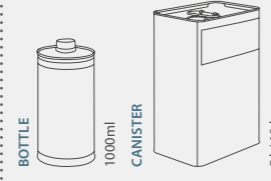
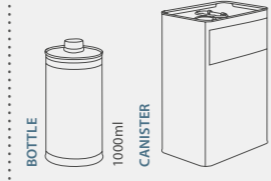
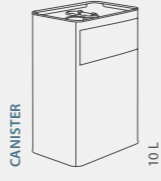

Flat roof

Our COSMO® adhesives by comparison

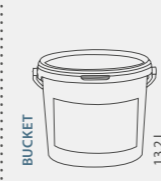
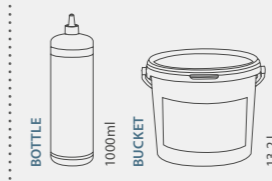
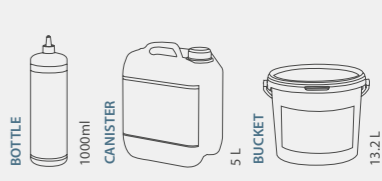
								
Product designation	COSMO® CL-300.120	COSMO® CL-300.330	COSMO® SL-640.110	COSMO® PU-160.640	COSMO® PU-160.110	COSMO® HD-120.140	COSMO® SP-830.171	COSMO® SP-830.180
Product	PVC cleaner	FPO / TPO cleaner	Solvent welding agent	Adhesive for roofing sheets	Adhesive for insulating material	Coating mass	Primer	Primer
Basis	Mixed mono carbonic acid esters	Mixed aliphatic ketones and hydrocarbons	Mixture of organic solvents	PUR	PUR	STP	Aqueous polymer dispersion	Aqueous acrylate-polymer dispersions
Application	1	1	2	3	4	5	6	6

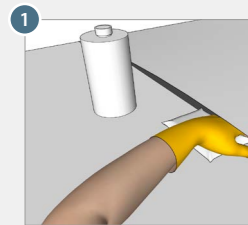

1 Pre-treatment for welding of roofing sheets made of PVC and FPO-/TPO by means of the cleaning agents **COSMO® CL-300.120** and **COSMO® CL-300.330**. The cleaners provide for a homogeneous and safe welding result by hot-air drier.

! Please find further information on page 32.

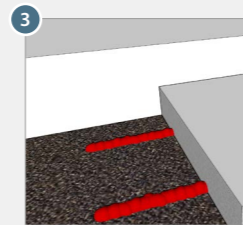

3 Bonding of insulating materials (mineral wool, PUR-, PS-foam) on different bituminous roofing sheets (sanded, slaty, etc.) as well as PVC sheets with fleece on different insulating materials (mineral wool, PUR-, PS foam) using the roof-sheet adhesive **COSMO® PU-160.640**

! Please find further information on page 32.

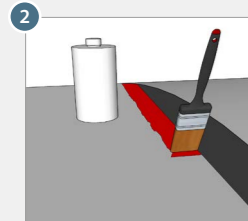

2 Welding of plastic roofing sheets using the solvent welding agent **COSMO® SL-640.110**

! Please find further information on page 32.

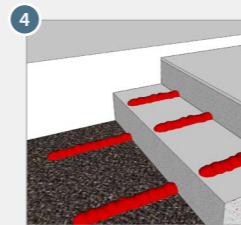

4 Bonding of insulating materials for roofs, e.g. polyurethane and phenolic-resin hard-foam, mineral wool and polystyrene, (EPS and XPS). Filling of cavities between individual heat insulation elements using the adhesive for insulating materials **COSMO® PU-160.110**

! Please find further information on page 33.

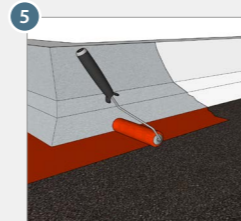

5 Coating mass for horizontal and conditionally vertical surfaces indoors and outdoors, e.g. rain gutters, pipe sleeves, cracks in roofs, walls and floors, complex connections of details, other components, surface bonding with **COSMO® HD-120.140**

! Please find further information on page 33.

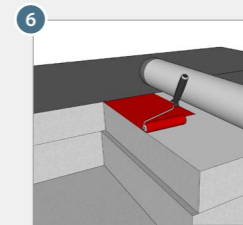

6 Adhesion promotion/improvement of acrylate, butyl and bitumen adhesive tapes, as well as self-adhesive plastic sheets on various substrates with primers **COSMO® SP-830.171** and **COSMO® SP-830.180**

! Please find further information on page 33.

Cement veil remover

Rapid Cleaner

Nature of the product:
Colourless liquid

Packaging:
1 l bottle: 0600-00100
10 l canister: 0600-01000

Properties:

The Rapid Cleaner is an acidic cleaner with high efficiency. It does not leave any calcareous stains and is free from hydrochloric acid! **It is not suitable for acid-sensitive natural stones, such as marble, slate, and Solnhofener plates.**



Dosing:

Final cleaning of buildings, cleaning of stone and concrete façades: Dilution 1:10 to 1:20 (5 – 10 %), first thoroughly soak the joints with water. Cleaning of drinking water storage containers (elevated tanks): Dilution 1:10 to 1:30 (3 – 10 %). Thoroughly rinse with clear water.

Grout cleaner

PUDOL Grouting Wipes

Nature of the product:
Cleaning cloth with impregnating solution (300 x 260 mm)

Packaging:
70 wipes / bucket: 8126 - 00000

Properties:

For cleaning and preparing of smooth joint flanks, e.g. for tiles, marble and granite, glass, metals, plastic materials, linoleum and many more before grouting. It does not leave residues. Absolutely lint-free wipe made of strongly wear-resistant fleece with cleaning substances in a reclosable dispensing bucket.



Dosing:

Open the bucket by the cover and pull out the wet cloth. Tear off the wipe on the perforation and reclose the cover! Wipe the surface and allow it to dry.

Graffiti remover

PUDOL XXL

Nature of the product:
Slightly yellowish paste

Packaging:
1 kg bucket: 3200-00100
10 kg bucket: 3200-01000

Properties:

Especially effective for strong pollutions on porous materials, e.g., house walls, concrete walls, as well as sight and noise prevention barriers. Be careful with plastic surfaces, do not use on plexiglass. PUDOL XXL infiltrates unwanted spray paints and paints and then, they can be removed easily.

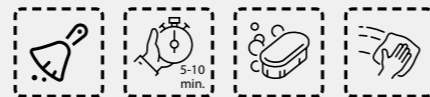

Dosing:

Apply undiluted using a brush or sponge and allow it to act for 5 to 10 minutes. Take the diluted paint layer off using an absorbent rag. Repeat the procedure for several times using a clean cloth. After that, thoroughly rewash the whole surface.

Green growth remover

GrünEX - Special Cleaner

Nature of the product:
Colourless liquid

Packaging:
1 l bottle: 1230-00100
10 l canister: 1230-01000

Properties:

GrünEX Special Cleaner is highly concentrated and with its depot-long-time effect its application is very efficient. It removes green layers and cleans the surfaces sustainably. We recommend its application on dry days. The surface will appear like the original surface and will be clean.



Dosing:

Dosing depends on how strong the pollution is: For strong pollutions, dilute it 1:10 with water, wet the surface and let it act for a while (sufficient for 20 30 m²). For slight pollution, a dilution of 1:20 to 1:50 will be enough, (sufficient for approx. 200 to 250 m²).

Power Cleaner

Multiclean Power Cleaner

Nature of the product:
Slightly blue, clean liquid

Packaging:
1 l bottle: 1925-00100
10 l canister: 1925-01000
200 l barrel: 1925-20000

Properties:

Multiclean is strongly dirt-dissolving and degreasing, and solvent-free, Free from CFC, non-flammable and has optimum wetting and emulsifying effects. Best results are already obtained if it is diluted with cold water, however in extreme cases, hot water improves the effect. Foam formation is in the medium range.

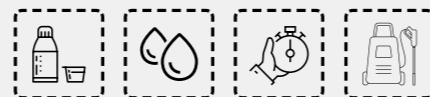

Dosing:

Continuous cleaning: 2% to 4% (1:50 to 1:25)
Application in high-pressure devices:
• Stock solution: 20% to 33% (1.5 to 1:3)
• Final dilution: 1% to 2%. (1:100 to 1:50)
As cold cleaner for motors and machines:
100% – Application time 15 min.
Cleaning of hardware:
• Strong pollution: 100% – Application time 15 min
• Normal pollution: 5% to 10% (1:20 to 1:10) – application time 15 min.



Careful dealing with environment and nature are not only of particular importance for us today, but also for future generations. **Weiss Chemie + Technik** continuously considers power economy, processes, products, packaging and transport routes, to contribute to a sustainable life cycle assessment and to a more sustainable future.

WHAT WE DO...

.. IN THE PRODUCTION

- Energy generation with photovoltaic system
- No loss of heat in the buildings – heat-accumulating insulation
- Optimised, energy-efficient and internal movement of goods by warehouse management system
- Use of electric forklift trucks
- Energy-efficiency in production and filling area by process control system
- Sewage treatment plant
- Reduction of harmful substances, e.g. by activated carbon filters and exhaust ventilation systems
- Regular environmental assessment by DEKRA Stuttgart
- Lived waste separation / disposal
- Recycling in production and administration

...WITH THE PRODUCT

- Sustainability confirmed by marking with the EMICODE®-Seal EC 1^{PLUS} for products with very low emission
- Targeted selection of raw materials and additives that are not subject to marking if possible
- Sustainability by using self-generating raw materials documented by the certification for bio-based products („DIN-certified bio-based“- test symbol of DIN CERTCO belonging to the TÜV Rheinland)
- Use of regenerated materials
- Use of recyclable packaging
- Sustainable value added chain
- Sourcing with focus on Germany and Europe
- Use of XPS foams without FCKW

...IN TRANSPORT

- Optimised transport capacities
 - Selection of sustainable networks of suppliers / forwarding companies (>80% of the supplier network in the EU)
- Our forwarding company:
- Reduced its CO2 emissions during the last 10 years by 27%
 - Is working in the NET CERO CARBON program → it smooths the way to carbon neutrality

THE "DIN-CERTIFIED BIO-BASED" LABEL

A neutral and transparent quality label regarding the content of bio-based carbon and the product quality makes finding resource-efficient products easier. By using the "DIN-certified bio-based" label, it is certified that we use bio-based raw materials and undergo regular monitoring.



LOW-EMISSION ADHESIVES FROM WEISS

GEV-EMICODE®-licensed products

The EMICODE® is a recognised standard for construction products (including adhesives) promoting healthy living and is a quality label for the proof of low VOC emissions. Products labelled with EMICODE® are modern, solvent-free, and low-emission building products.



Our service and advisory performances

Weiss, your competent and strong partner

We strongly support you!

Weiss is representing top performance in the areas of **adhesive and composite panel technology**.

For many decades, Weiss has been very successful in setting new market standards in terms of quality and excellent service. With our comprehensive product line of adhesives and sandwich panels, we are covering a wide variety of different applications.

Expert advice and service are counted to the elementary core competencies of our company. For all technical questions referring the application of our products, the competent technicians of our Service Center will be available for you with their specialist knowledge.



Our Service centre is available for you:

+49 (0) 2773 / 815-255
+49 (0) 2773 / 815-274

Our service and advisory performances

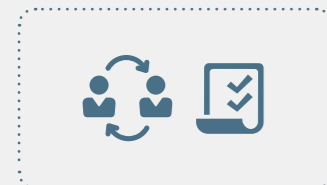

Support with the creation of the requirement specifications



Expert advice on the selection of adhesives



Optimisation tips for the design of the bonding surfaces



Rationalisation proposals for work flows



Recommendation of suitable dosing units as well as application and pressing technology



Optimisation of workstations for the processing of adhesives



Expert advice on all questions referring dangerous substances and goods



Creation and modification of adhesives in our Research and Development department

Private label

Three steps to private label

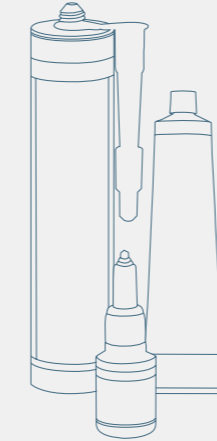

3 simple steps to your private label!

We are producing and making up our products with the individual design (private label) of our customers and we will be pleased to do this also for you!

We are offering special flexibility as well as long-term experience and respond with sensitivity on your wishes. Your own brand can profit from the high quality and reliability of our products.

Order easily and simply your private label adhesive in only 3 steps.

Step 1:

Select your desired trading unit and the type of adhesive from our standard product range.



Step 2:

Select the suitable standard packaging and the number of units in the box and on the pallet.

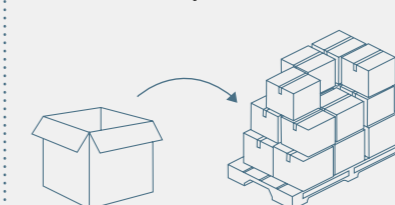

Step 3:

Send us your prepared label for the trading unit and/or for the card box.

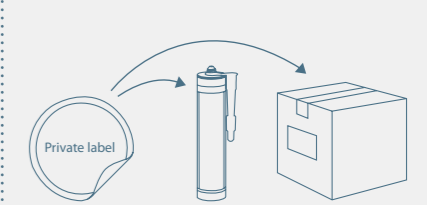

Moreover, Weiss is offering an all-around carefree package to implement your private label optimally and as desired:

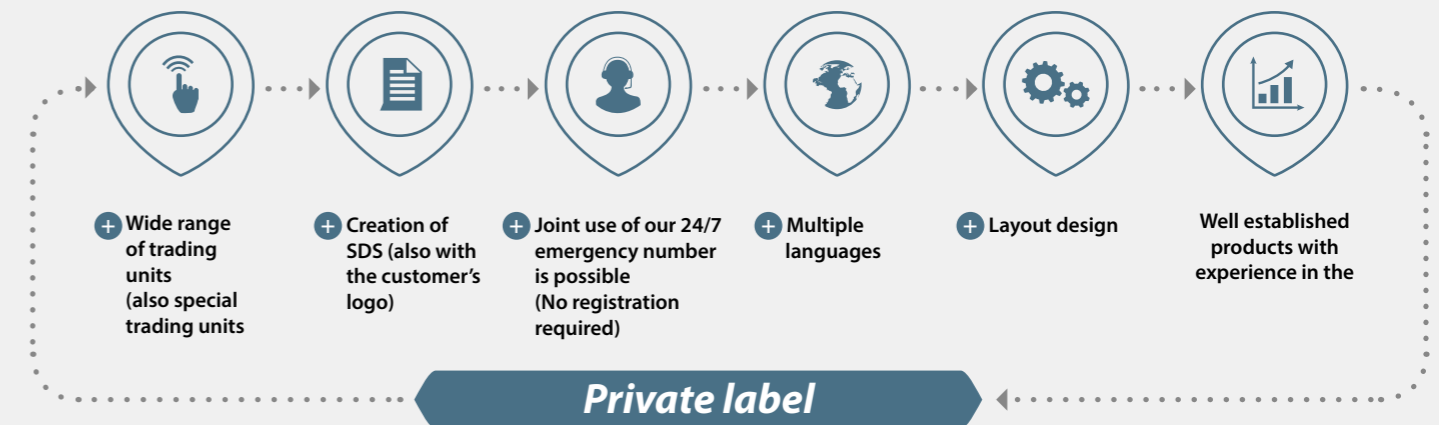

An overview of our range of products

Experience quality on a completely new level, with the powerful products by Weiss:



COSMO® Adhesives

Durably firm bond joints

COSMO® CA (Cyanoacrylates)
COSMO® PU (Polyurethane adhesives)
COSMO® CL (Cleaning agents)
COSMO® SL (Diffusion adhesives)
COSMO® HD (Hybrid adhesives)
COSMO® EP (Epoxy-resin adhesives)
COSMO® DS (Dispersion adhesives)
COSMO® SP (Service products)

Fields of application

- + Windows and doors
- + Transportation / Marine engineering
- + Industry
- + Assembly
- + Dry construction
- + Airtight bonding
- + Wood / Furniture industry
- + Container construction
- + Composite panels
- + Fire protection
- + Advertising industry

Do you have any questions?

**Our Service Center
Adhesives Division:**

+49 (0) 2773 / 815 - 255
+49 (0) 2773 / 815 - 274



COSMO® Composite Panels

Unlimited possibilities for design

COSMO® Therm (heat-insulating)
COSMO® Silent (sound insulating)
COSMO® Protect (penetration-resistant)
COSMO® Design (grooved)
COSMO® Tech (individual)
COSMO® Frame (frame widening)

Fields of application

- + Window and façade
- + Door construction
- + Industry
- + Automotive manufacturing
- + Trailer construction
- + Partition panel construction
- + Gate construction
- + Container construction
- + Energy conservation
- + Fire protection
- + Burglar resistance
- + Sound proofing

Do you have any questions?

**Our Service Center
Composite Panels Division:**

+49 (0) 2773 / 815 - 321

**Our Service Center
Façade Division:**

+49 (0) 5245 / 9241 - 21



PUDOL Cleaning and maintenance products

Cleanliness refreshes your senses

PUDOL SOFT
Mild cleaning agent for sensitive materials
PUDOL CARE
Maintenance product for high gloss and hygiene
PUDOL POWER
Powerful cleaning agent for extreme pollution
PUDOL FRESH
Cleaning agent for cleanliness and fresh air

Fields of application

- + FLOORING
- + Sanitary area
- + Clothing care
- + Food industry
- + Household and gastronomy
- + Windows and glass
- + Dishwasher
- + Carpet and upholstery
- + Industry and workshop
- + Cars
- + Skin cleaning
- + Skin protection

Do you have any questions?

Our Service Center PUDOL:

+49 (0) 2743 / 9212 - 0

weiss

Plant I
Weiss Chemie + Technik
GmbH & Co. KG
Hansastr. 2
D-35708 Haiger

Phone: +49 (0) 2773 / 815 - 0
Fax: +49 (0) 2773 / 815 - 200
E-mail: ks@weiss-chemie.de

www.weiss-chemie.de

Plant II
Weiss Chemie + Technik
GmbH & Co. KG
Siemensstr. 8
D-33442 Herzebrock-Clarholz

Phone: +49 (0) 5245 / 9241 - 0
Fax: +49 (0) 02773-815-300
E-mail: se@weiss-chemie.de

PUDOL



**A subsidiary of the
Weiss Group**

Pudol Chemie GmbH & Co. KG
Bahnhofstr. 2
D-57520 Niederdreisbach

Phone: +49 (0) 2743 / 9212 - 0
Fax: +49 (0) 2743 / 9212 - 71
E-mail: info@pudol.de
www.pudol.de

Cleanliness refreshes your senses

made by weiss